

# PACKARD ELECTRIC DIVISION

GENERAL MOTORS CORPORATION

WARREN, OHIO

12-A  
PEB-A  
63-R  
74-R  
311-R  
320-R  
330-R  
350-R  
900-R  
952-R  
952T-R  
ACS-V  
PEB-R

DO NOT SCALE

THIS DRAWING AND DESIGN HEREON CONSTITUTE A PROPRIETARY DESIGN OF PACKARD ELECTRIC DIVISION AND IS NOT TO BE DUPLICATED OR REPRODUCED WITHOUT AUTHORITY OF PACKARD ELECTRIC DIVISION.

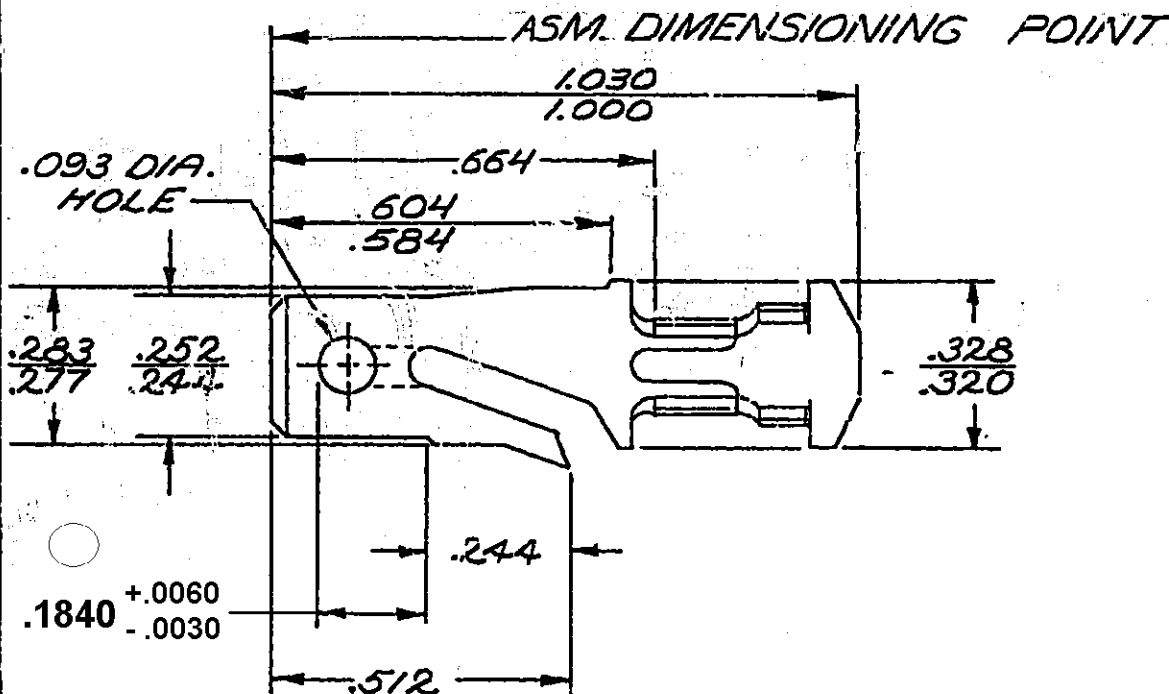

CONDUCTOR WINGS FOR  
0.8 MM<sup>2</sup> CABLE.

INSULATION WINGS  
FOR 3.13 MM MAX INSUL.  
DIA.

2460-R  
3200-R  
2252-R  
2371-R

PEL-R  
PEB-R  
PEB-R

-OUTLINE DRAWING-

PART NO.

2965439

SIZE

A

DATE	SYM	REVISION RECORD	C/N NO.
12-23-59	Q	REVISED & REDRAWN	21342
6-15-60	Q	VIEW & DIM. ADDED	1808
2-9-61	Q	123 WAS 155	3830
9-13-66	Q	DIM. & DIMENSIONING POINT REVISED	25293
		MAT'L SPEC WAS .032	
		BRASS-TIN PLATED	
8-6-69	Q	2962864 "D" SIZE	36500
		SHT "1" WAS 2962864-D	
04SE79	-	CABLE REVISED TO METRIC	70845
01SE82	-	PICTURE REVISED	82155
01AUB3	AY	REV. SYM. ADVANCED	86126
05DE05	AY5	ADDED DIM .1840 +.0060/-0.0030 AND REMOVED DIM (1 PLC)	274727

CODE NO. 6900

TOLERANCE UNLESS  
OTHERWISE SPECIFIED  
DECIMAL  $\pm .005$   
FRACTIONAL  
ANGULAR  $\pm 2^\circ$

DWG. DATE 2-28-57 SCALE NONE

DR. PLYLER

ROUTING  
DEPT.  
OUTST.

CK. *Page 1-8-60*  
APPR. *1-11-60*

REFERENCE  
2962864 "D" SIZE-SHT. 1

APPR. *1-11-60*  
APPR. *1-11-60*

MATERIAL SPEC  
.0320 THK. SAE CA 260-BRASS  
1/2 HARD-TIN PLATED

CODE NO.

NAME  
TERMINAL-MALE-'56 SERIES

PART NO.

2965439

SIZE

A

# Mouser Electronics

Authorized Distributor

Click to View Pricing, Inventory, Delivery & Lifecycle Information:

[Delphi Connection Systems:](#)

[02965439](#)