

# TNC Female Jack

161-9421

KOBI CONN

TNC Female Jack

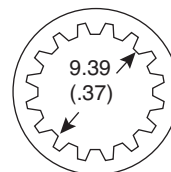
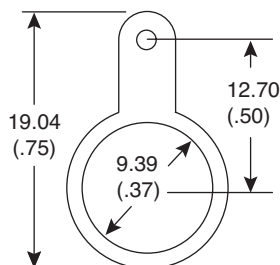
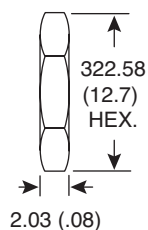
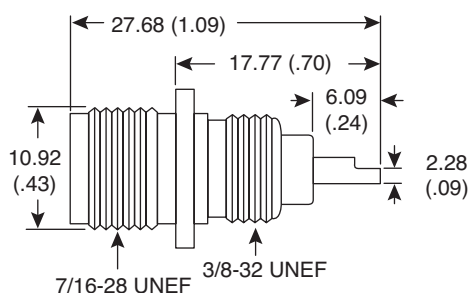
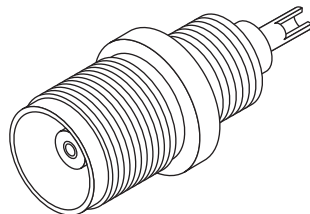

Dimensions: mm (In.)

## SPECIFICATIONS

Type:	TNC female chassis receptacle
Pins:	nickel plated
Insulators:	Delrin
Compatible:	with comparable industry types
For:	instrumentation, medical equipment

Date Last Revised: 4-20-06

Available from Mouser Electronics  
1-800-346-6873  
www.mouser.com

KC-300588

161-9421