

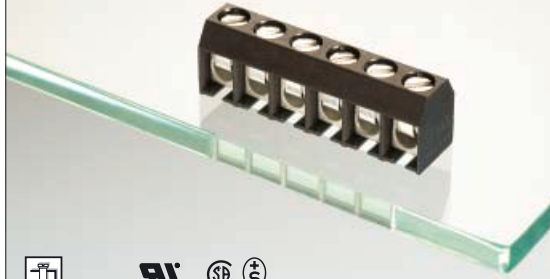

Type 101

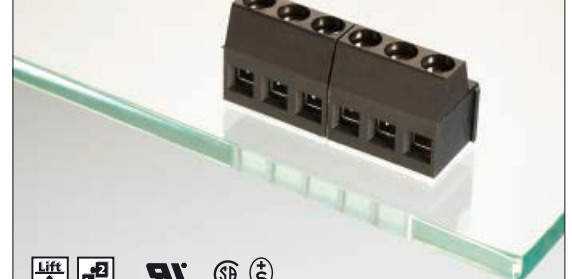

Type 15



Description Type 101

Screw type terminal block, solderable, centerline 5.08 mm / 0.200 inch, wire entry horizontal, wire protector

Technical Data Type 101

V / A / AWG	300 / 15 / 28 - 14	
V / A / AWG	300 / 15 / 28 - 14	
0.08 - 1.5 mm ²	125 V / 2.5 kV / 3 / 13 A	
Wire diameter	single wire 0.3 - 1.6 mm 0.012 - 0.063 in.	
Insulation co-ordination according to IEC 60664-1	Clearance and creepage distance ≥ 2.7 mm / 0.106 in.	
Wire strip length	6 mm / 0.236 in.	
Screw torque	max. 0.5 Nm / 7 lbs.-in	
Solder pin	Ø 0.9 mm / Ø 0.035 in. recommended pc board hole dia. 1.2 mm / 0.047 in.	
Solder pin length	3.8 mm / 0.149 in.	
Pole size	2 - 10	
Colour	black	

Dimensions in mm 1 mm = 0.039 in.

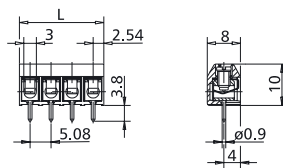

L = (pole size - 1) x centerline + 5.08 mm / 0.200 in.

Description Type 15

Screw type terminal block, solderable, centerline 5.08 mm / 0.200 inch, wire entry horizontal, lift system, modular

Technical Data Type 15

V / A / AWG	300 / 15 / 22 - 14	
V / A / AWG	300 / 15 / 22 - 14	
0.08 - 1.5 mm ²	250 V / 4 kV / 3 / 13 A	
Wire diameter	single wire 0.3 - 2 mm 0.012 - 0.079 in.	
Insulation co-ordination according to IEC 60664-1	Clearance and creepage distance ≥ 3.9 mm / 0.154 in.	
Wire strip length	7 mm / 0.276 in.	
Screw torque	max. 0.5 Nm / 8 lbs.-in	
Solder pin	0.8 x 1 mm 0.031 x 0.039 in. recommended pc board hole dia. 1.4 mm / 0.055 in.	
Solder pin length	4.1 mm / 0.161 in.	
Pole size	2, 3	
Colour	black	

Dimensions in mm 1 mm = 0.039 in.

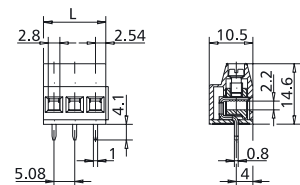

L = (pole size - 1) x centerline + 5.08 mm / 0.200 in.

Type 101 centerline 5.08 mm / 0.200 in.

P/N 311011 __ 02 03 04 05 06 07
08 09 10 (pole size)
- complete __ the part number by adding the pole size.
- other pole sizes consult factory.

Type 15 centerline 5.08 mm / 0.200 in.

P/N 310151 __ 02 03 (pole size)
- complete __ the part number by adding the pole size.
- other pole sizes consult factory.