

EAO – Your Expert Partner for Human Machine Interfaces

704.010.0 - Pushbutton actuator

704.010.0 - Pushbutton actuator

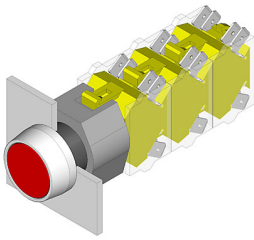

Attention: The preview is based on a sample product. This can differ from your current configuration.

Mounting

Mounting cut-out Ø 22.5 mm
Design raised

Front

Front shape round
Front dimension Ø 29 mm
Front ring material Plastic
Front ring colour grey

Other Attributes

Weight 0.040 kg

Operating-/Indication part

Lens optics opaque
Lens material Plastic
Lens colour black
Lens profile flat

IP-Rating

Front protection IP 65

Actuator

Switching action Momentary
Housing material Plastic
Housing colour grey

Function

Pushbutton

EAO – Your Expert Partner for Human Machine Interfaces

704.010.0 - Pushbutton actuator

Dimensions

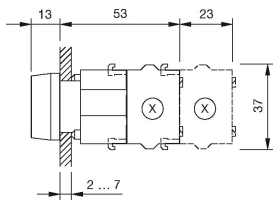

X = Screw terminal

Mounting cut-outs

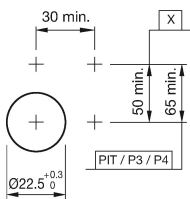

PIT = Push-in terminal

Wiring diagram



Additional information

Frontring with protective cover to be mounted with a torque of 40 Ncm onto actuator
Max. 3 switching elements can be clipped on

Legend

Switching action: B = Momentary