

Professionally approved products.

## Datasheet

# IP65 Panel Mount Momentary Illuminated Push Button Switch, 8 A

RS Stock 745-2467



### CONFIGURATION

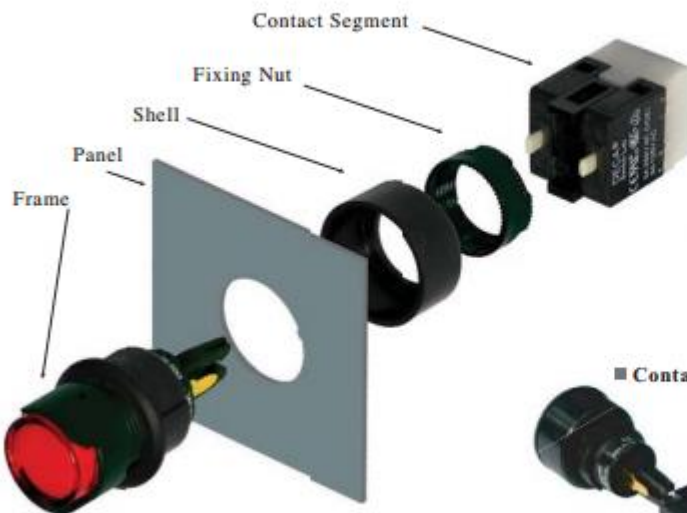

### ■ Detachment of the Contact Assembly

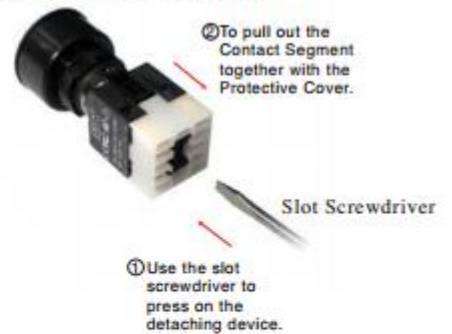

### ■ Contact Assembly



### ■ Protective Cover is detachable



# **Professionally approved products.**

## **Datasheet**

### **Specifications**

- Electrical Lifetime: 50,000 operations min
- Electric Rating: 250V AC (VDE) 125V AC 8A
- Max. insulation voltage: 2000V 60HZ 1min. Between all terminals and ground
- Motion Tolerance: <60 operation/min
- Insulation Resistance: >50 Mega- ohms
- Contact Material: Silver
- Storage Temperature: -40°C to +70°C
- Operating Temperature: -25°C to +55°C