

Bead Inductors (Lead Type)

[RoHS Compliant]

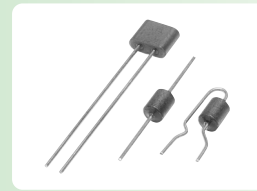

Model	Rated current DC (A)	Impedance (Ω)	Operating temperature range (°C)
B-01-Series	5	2 (at 1 MHz)	-20 to +70
B-02-Series		4 (at 1 MHz)	
B-03-Series		5 (at 1 MHz)	
B-06-Series		40 (at 10 MHz)	

Note: Rated current values are not guaranteed by impedance levels; these values are permissible levels when the lead wire temperature rise is 20°C.

Model	Shape	Packaging
B-01-R	Single-bead, radial-lead	Bulk type (100 pcs./bag)
B-01-RT	Single-bead, radial-lead	Tape type (2000 pcs./reel)
B-01-RTF	Single-bead, radial-lead	Tape type (2000 pcs./box)
B-01-RS	Single-bead, radial-lead	Bulk type (100 pcs./bag)
B-01-RTS	Single-bead, radial-lead	Tape type (2000 pcs./reel)
B-01-RTSF	Single-bead, radial-lead	Tape type (2000 pcs./box)
B-01-A	Single-bead, axial-lead	Bulk type (100 pcs./bag)
B-01-A1	Single-bead, axial-lead	Bulk type (250 pcs./bag)
B-01-A2	Single-bead, axial-lead	Bulk type (250 pcs./bag)
B-01-AT	Single-bead, axial-lead	Tape type (5000 pcs./reel)
B-01-ATF	Single-bead, axial-lead	Tape type (1500 pcs./box)
B-01-AT1F	Single-bead, axial-lead	Tape type (2000 pcs./box)
B-02-R	Double-bead, radial-lead	Bulk type (100 pcs./bag)
B-02-RT	Double-bead, radial-lead	Tape type (2000 pcs./reel)
B-02-RTF	Double-bead, radial-lead	Tape type (2000 pcs./box)
B-03-R	Double-bead, radial-lead	Bulk type (100 pcs./bag)
B-03-RT	Double-bead, radial-lead	Tape type (2000 pcs./reel)
B-06-R-25	Double-bead, radial-lead	Bulk type (100 pcs./bag)
B-06-RTF-25	Double-bead, radial-lead	Tape type (1500 pcs./reel)
B-06-R-50	Double-bead, radial-lead	Bulk type (100 pcs./bag)
B-06-RTF-50	Double-bead, radial-lead	Tape type (1500 pcs./box)

Impedance Characteristics

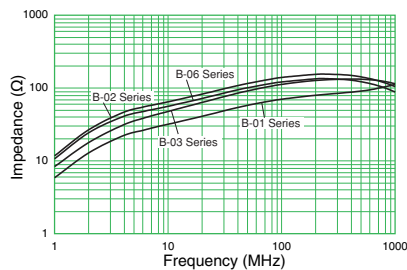

- All specifications in this catalog and production status of products are subject to change without notice. Prior to the purchase, please contact NEC TOKIN for updated product data.
- Please request for a specification sheet for detailed product data prior to the purchase.
- Before using the product in this catalog, please read "Precautions" and other safety precautions listed in the printed version catalog.

Shape and Dimensions

●B-01-R Series

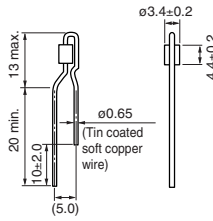

●B-02-R Series

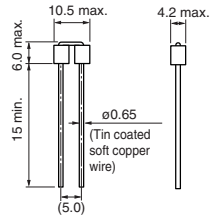

●B-06-R-25 Series

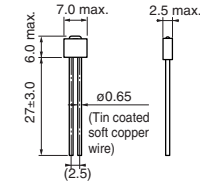

●B-01-RS Series

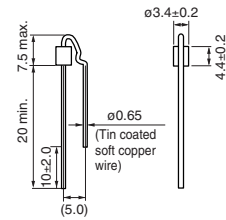

●B-03-R Series

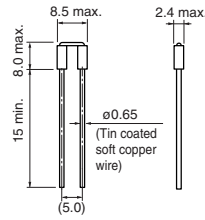

●B-06-R-50 Series

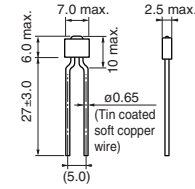

●B-01-A Series

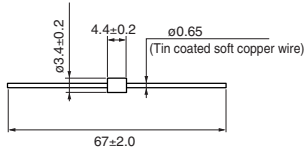

●B-01-A1

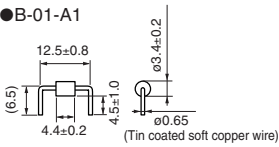

●B-01-A2

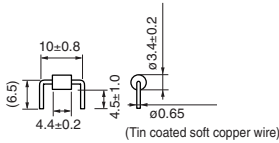

[mm]



- All specifications in this catalog and production status of products are subject to change without notice. Prior to the purchase, please contact NEC TOKIN for updated product data.
- Please request for a specification sheet for detailed product data prior to the purchase.
- Before using the product in this catalog, please read "Precautions" and other safety precautions listed in the printed version catalog.

Tape and Reel Dimensions

●B-01-RT • RTF

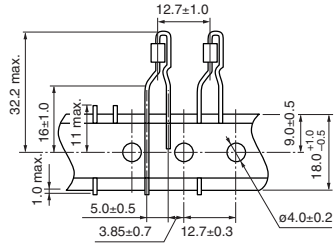

●B-02-RT • RTF/B-03-RT

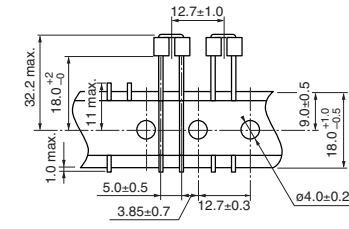

●B-01-RTS • RTSF

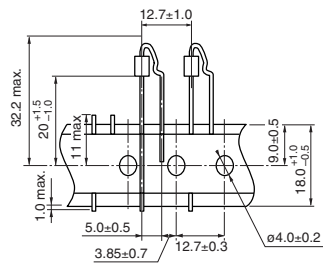

●B-06-RTF-25

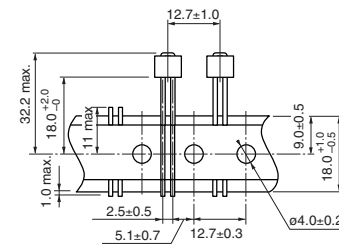

●B-01-AT • ATF

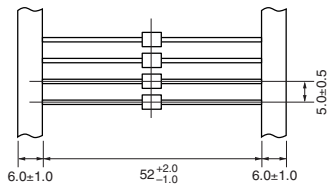

●B-06-RTF-50

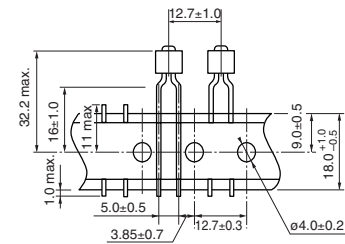

●B-01-AT1F

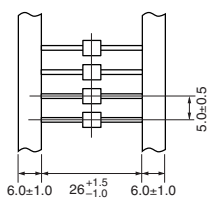

[mm]

DC Line Filters VOL.08



- All specifications in this catalog and production status of products are subject to change without notice. Prior to the purchase, please contact NEC TOKIN for updated product data.
- Please request for a specification sheet for detailed product data prior to the purchase.
- Before using the product in this catalog, please read "Precautions" and other safety precautions listed in the printed version catalog.