

Solder Cup – Basic D Series – Metal Shell



[Features](#) | [Part Numbers](#) | [Dimensions](#)

Features

Solder Cup style for wire termination.

- Offered with .120 mounting holes, 4-40 clinch nuts, and dual float bushings.
- Offered in 9, 15, 25, 37, and 50 position plugs and sockets.
- Available with gold flash.
- RoHS version available
- Approvals:
 - UL Recognized – Files E170218 (UL1977) and E130965 (UL1863).
 - CSA Approved – File LR31996.

Materials

- Insulator Material: Glass-filled polyester (white), UL 94V-O rated
- Connector Shell: Steel with zinc plating and yellow chromate finish or tin plating (grounding indents on plug), RoHS zinc plated with clear chromate
- 4-40 Clinch Nut: Steel with cadmium plating and yellow chromate finish. RoHS zinc plating with clear chromate finish.

Mechanical

- Individual Contact Insertion and Separation Force (minimum/maximum): 0.7 oz./12 oz.

Durability

- 500 mating cycles

Electrical

- Withstanding Voltage: Minimum 1250V RMS @ sea level
- Current Rating: 5 Amps
- Contact Resistance: 2.7 milliohms maximum
- Insulation Resistance: 5000 megohms maximum (initial); 1000 megohms (minimum) after environmental testing

Environmental

- Operating Temperature: -65°C to + 125°C
- Shock: 50G peak per MIL-STD-202, Method 213, Condition G
- Vibration: 12 cycles in three perpendicular directions @ 10-2000Hz, per MIL-STD-202, Method 204, Condition D
- Moisture Resistance: 90-95% relative humidity @ 40°C for 96 hours per MIL-STD-202, Method 103

[back to top](#)

Part Numbers

Stamped Contact with Gold Flash in Solder Cup

9	DE-9P	DEE-9P
15	DA-15P	DAE-15P
25	DB-25P	DBE-25P
37	DC-37P	DCE-37P
50	DD-50P	DDE-50P

Stamped Contact with Tin/Lead in Solder Cup

9	DE-9P-II	DEE-9P-II	Discont
15	DA-15P-II	DAE-15P-II	Discont
25	DB-25P-II	DBE-25P-II	Discont
37	DC-37P-II	DCE-37P-II	Discont
50	DD-50P-II	DDE-50P-II	Discont

RoHS Plugs – Stamped Contact w/Gold Flash in Solder Cup

9	DEH-9P	pdf	DEEH-9P	pdf
15	DAH-15P	pdf	DAEH-15P	pdf
25	DBH-25P	pdf	DBEH-25P	pdf
37	DCH-37P	pdf	DCEH-37P	pdf
50	DDH-50P	pdf	DDEH-50P	pdf

Stamped Contact with Gold Flash in Solder Cup

9	DE-9S	DEE-9S
15	DA-15S	DAE-15S
25	DB-25S	DBE-25S
37	DC-37S	DCE-37S
50	DD-50S	DDE-50S

Stamped Contact Tin/Lead in Solder Cup

9	DE-9S-II	DEE-9S-II	Discont
15	DA-15S-II	DAE-15S-II	Discont
25	DB-25S-II	DBE-25S-II	Discont
37	DC-37S-II	DCE-37S-II	Discont
50	DD-50S-II	DDE-50S-II	Discont

RoHS Socket- Stamped Contact w/Gold Flash in Solder Cup

9	DEH-9S	pdf	DEEH-9S	pdf
15	DAH-15S	pdf	DAEH-15S	pdf
25	DBH-25S	pdf	DBEH-25S	pdf
37	DCH-37S	pdf	DCEH-37S	pdf
50	DDH-50S	pdf	DDEH-50S	pdf

[back to top](#)

Dimensions

Contact Information

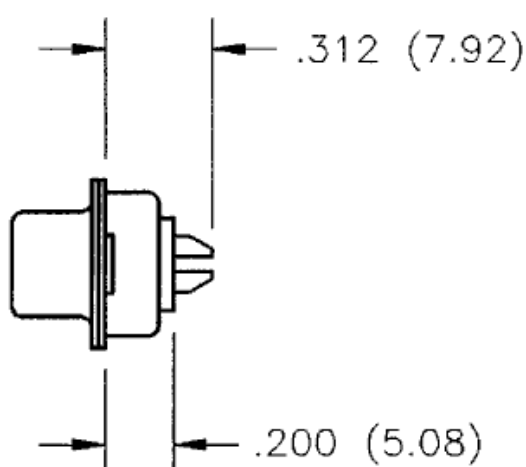

Stamped Contact will accommodate up to 20 AWG wire.

Materials

- Contact Material
 - Copper Alloy
- Contact Plating
 - Stamped contacts with gold flash on remainder. All over nickel.