

Features

- Schottky barrier diodes
- Low forward voltage drop
- Low leakage current
- Moisture sensitivity: level 1, per J-STD-020
- Solder dip 260 °C, 10 s
- Low profile, typical thickness 1.2mm

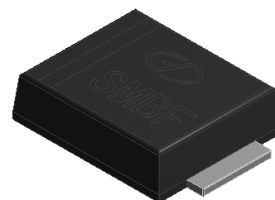

SMBF

Typical Applications

For use in low voltage,high frequency inverters,free wheeling, and polarity protection application

Maximum Ratings (TA = 25 °C unless otherwise noted)

Parameter	Symbol	SMBF520SL	SMBF530SL	SMBF540SL	SMBF545SL	Unit
Maximum repetitive peak reverse voltage	VRRM	20	30	40	45	V
Maximum RMS voltage	VRMS	14	21	28	31.5	V
Maximum DC blocking voltage	VDC	20	30	40	45	V
Maximum average forward rectified current	IF(AV) ¹⁾	5.0				A
Peak forward surge current 8.3 ms single half sine-wave superimposed on rated load	IFSM	150				A
Rating for fusing(t<8.3ms)	I ² t	93.8				A ² sec
Operating junction and storage temperature range	TJ, TSTG	- 55 to + 125				°C

Electrical Characteristics (TA = 25 °C unless otherwise noted)

Parameter	Test Conditions	Symbol	SMBF520SL	SMBF530SL	SMBF540SL	SMBF545SL	Unit
Minimum Breakdown voltage	Ta=25°C,IR=1mA	V _{BR}	20	30	40	45	Volts
Maximum Instantaneous forward voltage	IF=5A, Ta=25°C	VF	0.45				
	IF=5A, Ta=125°C		0.40				
Maximum DC reverse current at rated DC blocking voltage	Ta=25°C	IR	150				uA
	Ta=100°C		20				mA
Typical junction capacitance	4.0 V, 1 MHz	C _J	290				pF
Typical thermal resistance ¹⁾	juntion to ambient	R _{θJA}	62				°C/W
	juntion to case	R _{θJC}	25				
	juntion to lead	R _{θJL}	7				

Note1):Mounted on PCB with 8*8mm copper pad,2 OZ,FR4 PCB;

Ratings and Characteristics Curves

(TA = 25°C unless otherwise noted)

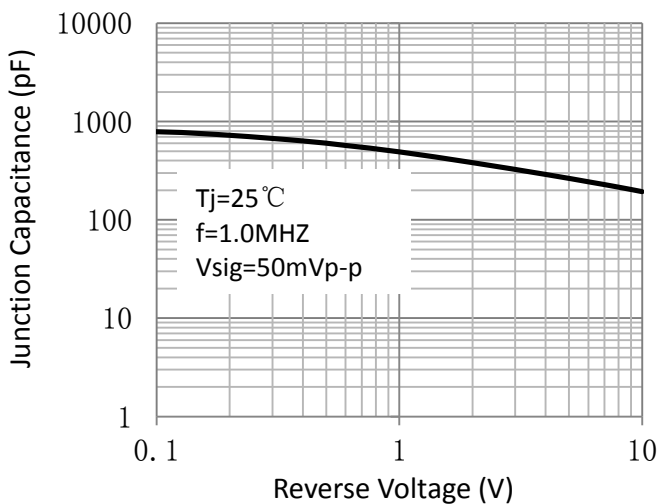
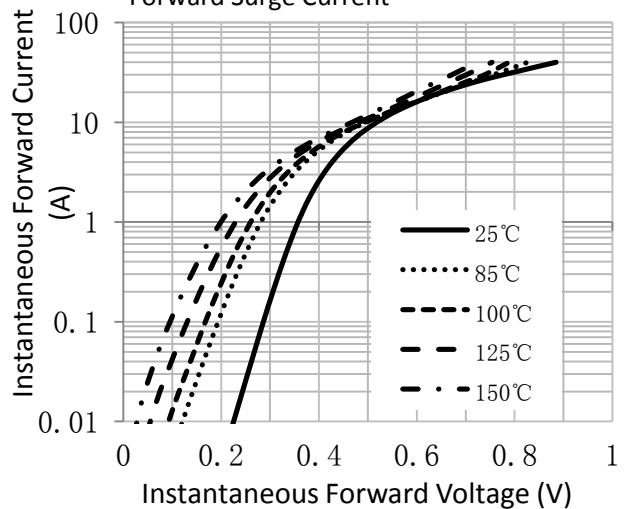
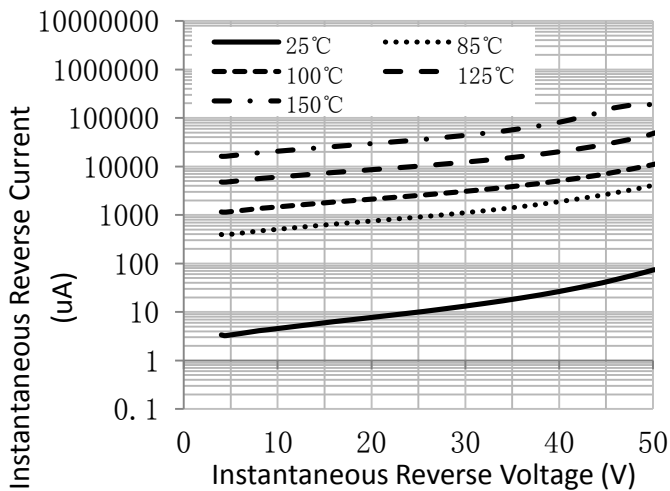
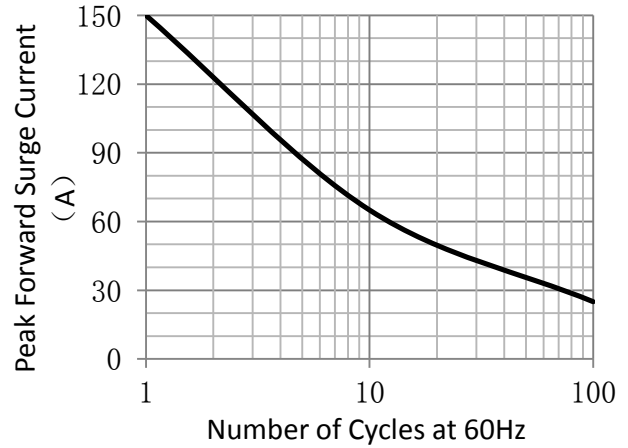
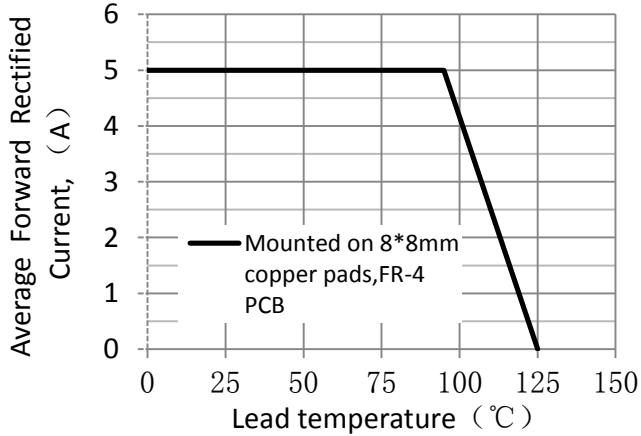

Package Outline Dimensions

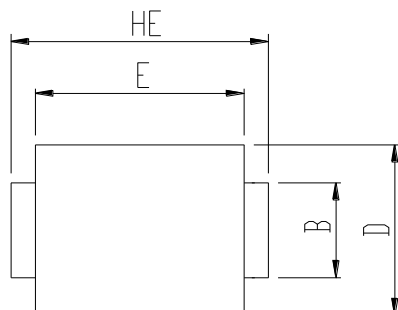

DIM	unit: mm		unit: inch	
	MIN	MAX	MIN	MAX
A	1.1	1.3	0.043	0.051
B	1.9	2.1	0.075	0.083
C	0.15	0.3	0.006	0.012
D	3.5	3.7	0.138	0.146
E	4.2	4.45	0.165	0.175
HE	5.1	5.5	0.201	0.217
L	0.75	1.2	0.030	0.047

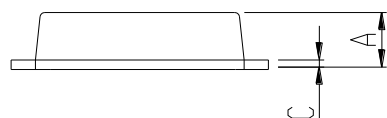

Soldering footprint

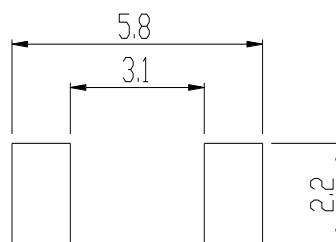
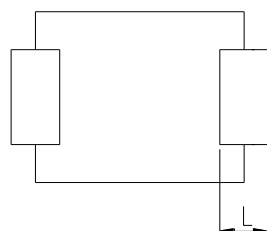

Packing Information

Packing quantities:

Reel size	Quantity/reel	Quantity/inner Box	Quantity/Carton
7"	TBD	TBD	TBD
13"	5K	10K	90K

Tape & Reel Specification

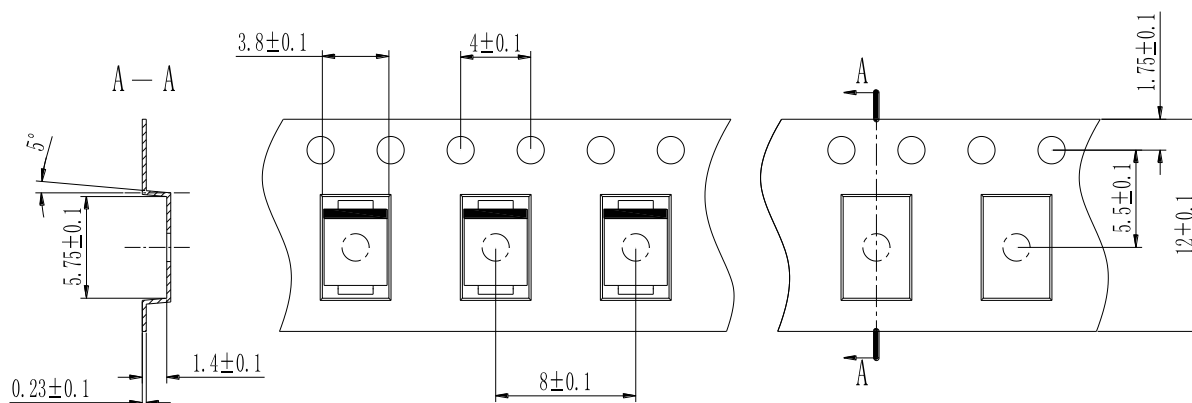



SMBF520SL thru SMBF545SL

Surface Mount Schottky Rectifier
Reverse Voltage 20~45V Forward Current 5A

Disclaimers

These materials are intended as a reference to assist our customers in the selection of the Suzhou Good-Ark product best suited to the customer's application; they do not convey any license under any intellectual property rights, or any other rights, belonging to Suzhou Good-Ark Electronics Co., Ltd. or a third party.

Suzhou Good-Ark Electronics Co., Ltd. assumes no responsibility for any damage, or infringement of any third-party's rights, originating in the use of any product data, diagrams, charts, programs, algorithms, or circuit application examples contained in these materials.

All information contained in these materials, including product data, diagrams, charts, programs and algorithms represents information on products at the time of publication of these materials, and are subject to change by Suzhou Good-Ark Electronics Co., Ltd. without notice due to product improvements or other reasons. It is therefore recommended that customers contact Suzhou Good-Ark Electronics Co., Ltd. or an authorized Suzhou Good-Ark Electronics Co., Ltd. for the latest product information before purchasing a product listed herein. The information described here may contain technical inaccuracies or typographical errors. Suzhou Good-Ark Electronics Co., Ltd. assumes no responsibility for any damage, liability, or other loss rising from these inaccuracies or errors. Please also pay attention to information published by Suzhou Good-Ark Electronics Co., Ltd. by various means, including our website home page.
(<http://www.goodark.com>)

When using any or all of the information contained in these materials, including product data, diagrams, charts, programs, and algorithms, Please be sure to evaluate all information as a total system before making a final decision on the applicability of the information and products. Suzhou Good-Ark Electronics Co., Ltd. assumes no responsibility for any damage, liability or other loss resulting from the information contained herein.

The prior written approval of Suzhou Good-Ark Electronics Co., Ltd. is necessary to reprint or reproduce in whole or in part these materials.

Please contact Suzhou Good-Ark Electronics Co., Ltd. or an authorized distributor for further details on these materials or the products contained herein.