



Features

- Carbon element
- Assortment of resistance tapers
- Variety of shaft lengths
- Flatted, knurled and slotted shaft styles
- Center detent option



PTM90 Series Panel Control w/ Push-Push Switch

Electrical Characteristics

Standard Resistance Range 1K ohms to 1 megohm
 Standard Resistance Tolerance
 R < 250K ohms ±20 %
 R ≥ 250K ohms ±30 %
 End Resistance
 R < 50K ohms 30 ohms max.
 R ≥ 50K ohms 0.1 % of TR max.
 Insulation Resistance @ 250 VDC
 100 megohms min.
 Dielectric Withstanding Voltage 300 VAC
 Tracking Error (-40 dB to 0 dB) ±3 dB
 Standard Taper Linear, Audio
 Power Rating
 Linear 0.05 watt
 Audio 0.025 watt
 Slider Noise 100 mV max.
 Operating Voltage 50 VAC / 10 VDC

Environmental Characteristics

Operational Life 15,000 cycles
 TR Shift ±15 %
 Operating Temp. Range -10 °C to +55 °C
 Resistance to Solder Heat ±5 %
 IP Rating IP 40

Mechanical Characteristics

Mechanical Angle 300 ° ±3 °
 Operating Torque 20~250 gf-cm
 Stop Strength 5 kgf-cm max.
 Mounting Torque 10 kgf-cm max.
 Shaft Push/Pull Strength 10 kgf max.
 Soldering Condition
 Manual 300 °C ±5 °C for 3 sec.
 Wave 260 °C ±5 °C for 5 sec.
 Wash Not recommended
 Hardware One flat washer and one mounting nut supplied with each potentiometer

Switch Characteristics

Power Rating 3 A @ 16 VDC
 Contact Resistance 100 milliohms
 Dielectric Strength
 Bushing to Terminals 300 VAC
 Switch Terminals 50 VAC
 Insulation Resistance
 Bushing to Terminals @ 250 VAC
 100 megohms
 Switch Terminals @ 50 VAC
 10 megohms
 Switch Type Push on - Push off
 Contact Arrangement SPDT
 Switch Stroke 1.5 ± 0.1 mm
 Operating Force 2 kgf max.
 Operating Life 10,000 cycles

Product Dimensions

Knurled Shaft

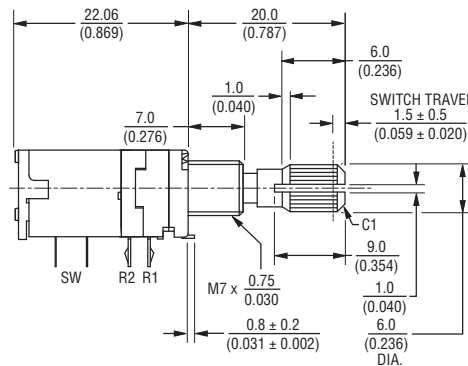

DIMENSIONS: $\frac{\text{MM}}{\text{(INCHES)}}$

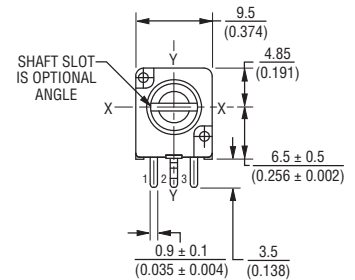

Slotted Shaft

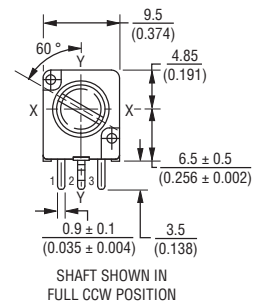
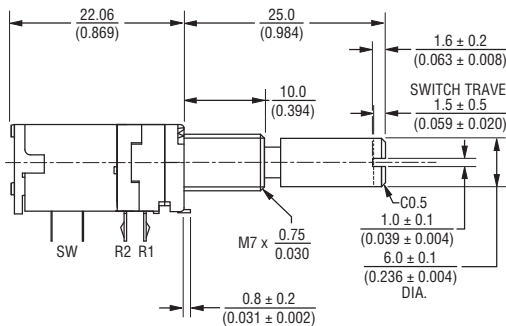

Flatted Shaft

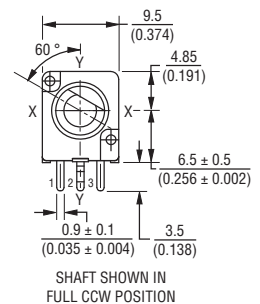
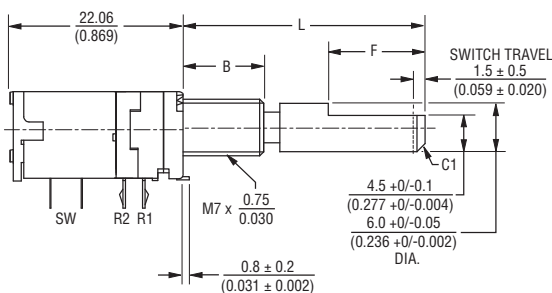

Dimensions		
L	$\frac{20}{(0.787)}$	$\frac{30}{(1.181)}$
B	$\frac{7}{(0.276)}$	$\frac{10}{(0.394)}$
F	$\frac{10}{(0.694)}$	$\frac{12}{(0.472)}$

*RoHS Directive 2002/95/EC Jan. 27, 2003 including annex and RoHS Recast 2011/65/EU June 8, 2011. Specifications are subject to change without notice.

The device characteristics and parameters in this data sheet can and do vary in different applications and actual device performance may vary over time. Users should verify actual device performance in their specific applications.

PTM90 Series Panel Control w/Push-Push Switch

BOURNS®

Mounting Hole Detail

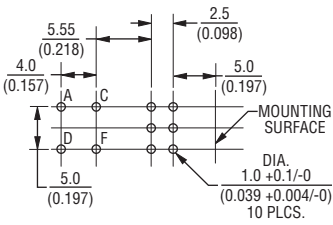

Locating Lug Detail



Tapers



Hardware



How To Order

PTM90 2 - 0 25 S - 103 B2

- Model Number
- Designator
 - PTM90 = Panel Control w/Push-Push Switch
- Number of Sections
 - 2 = Dual Gang
- Center Detent
 - 0 = No Detent
 - 1 = Center Detent
- Shaft Length (FMS)
 - 20 = 20 mm (Knurled and Flatted shaft)
 - 25 = 25 mm (Slotted shaft only)
 - 30 = 30 mm (Flatted shaft only)
- Shaft Style
 - F = Flatted Metal
 - K = Knurled (18 tooth serrated)
 - S = Slotted Metal
- Resistance Code (See Standard Resistance Table)
- Resistance Taper (See Taper Charts)
 - Taper Series followed by Curve Number

Standard Resistance Table

Resistance (Ohms)	Resistance Code
1,000	102
2,000	202
5,000	502
10,000	103
20,000	203
50,000	503
100,000	104
200,000	204
500,000	504
1,000,000	105

Switch Circuit

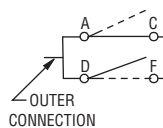

Schematic

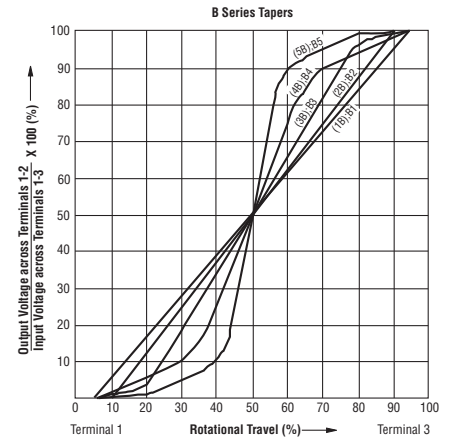

REV. 02/15

Specifications are subject to change without notice. The device characteristics and parameters in this data sheet can and do vary in different applications and actual device performance may vary over time. Users should verify actual device performance in their specific applications.

Mouser Electronics

Authorized Distributor

Click to View Pricing, Inventory, Delivery & Lifecycle Information:

Bourns:

[PTM902-125K-103B2](#) [PTM902-130K-502B2](#) [PTM902-030K-203B2](#) [PTM902-130S-102B2](#) [PTM902-025S-203B2](#)
[PTM902-125S-502B2](#) [PTM902-120F-202B2](#) [PTM902-125S-105B2](#) [PTM902-020S-105B2](#) [PTM902-025K-202B2](#)
[PTM902-025F-102B2](#) [PTM902-030K-204B2](#) [PTM902-030F-104B2](#) [PTM902-020F-204B2](#) [PTM902-130F-503B2](#)
[PTM902-120S-103B2](#) [PTM902-130S-203B2](#) [PTM902-025K-105B2](#) [PTM902-120F-105B2](#) [PTM902-130K-105B2](#)
[PTM902-020F-502B2](#) [PTM902-130S-504B2](#) [PTM902-120K-105B2](#) [PTM902-025F-202B2](#) [PTM902-120S-504B2](#)
[PTM902-030S-105B2](#) [PTM902-120K-502B2](#) [PTM902-020S-503B2](#) [PTM902-125K-203B2](#) [PTM902-020K-204B2](#)
[PTM902-030K-104B2](#) [PTM902-020F-104B2](#) [PTM902-130S-202B2](#) [PTM902-030S-502B2](#) [PTM902-025S-103B2](#)
[PTM902-025K-503B2](#) [PTM902-030K-103B2](#) [PTM902-030F-204B2](#) [PTM902-120F-503B2](#) [PTM902-125S-104B2](#)
[PTM902-025K-102B2](#) [PTM902-120S-204B2](#) [PTM902-130S-104B2](#) [PTM902-120F-504B2](#) [PTM902-120S-203B2](#)
[PTM902-125K-504B2](#) [PTM902-030F-105B2](#) [PTM902-030S-204B2](#) [PTM902-130F-203B2](#) [PTM902-120S-503B2](#)
[PTM902-120K-203B2](#) [PTM902-120F-104B2](#) [PTM902-030F-504B2](#) [PTM902-025S-105B2](#) [PTM902-120K-204B2](#)
[PTM902-130K-104B2](#) [PTM902-125F-103B2](#) [PTM902-020K-203B2](#) [PTM902-130F-502B2](#) [PTM902-130S-105B2](#)
[PTM902-020F-103B2](#) [PTM902-030F-203B2](#) [PTM902-020F-202B2](#) [PTM902-125F-202B2](#) [PTM902-120S-102B2](#)
[PTM902-025K-104B2](#) [PTM902-120S-104B2](#) [PTM902-025F-502B2](#) [PTM902-030F-102B2](#) [PTM902-125K-102B2](#)
[PTM902-020K-102B2](#) [PTM902-030K-202B2](#) [PTM902-130F-204B2](#) [PTM902-120K-504B2](#) [PTM902-125F-105B2](#)
[PTM902-025S-202B2](#) [PTM902-130F-105B2](#) [PTM902-030F-503B2](#) [PTM902-125K-503B2](#) [PTM902-130K-103B2](#)
[PTM902-020S-104B2](#) [PTM902-020K-503B2](#) [PTM902-025F-204B2](#) [PTM902-130S-502B2](#) [PTM902-030S-203B2](#)
[PTM902-020S-103B2](#) [PTM902-020K-504B2](#) [PTM902-025F-105B2](#) [PTM902-125S-103B2](#) [PTM902-030K-503B2](#)
[PTM902-025F-104B2](#) [PTM902-025S-504B2](#) [PTM902-025K-204B2](#) [PTM902-120S-202B2](#) [PTM902-120F-502B2](#)
[PTM902-125K-502B2](#) [PTM902-020F-203B2](#) [PTM902-025S-503B2](#) [PTM902-125F-203B2](#) [PTM902-030S-103B2](#)