

Data Sheet

P1K

Pressure Sensor

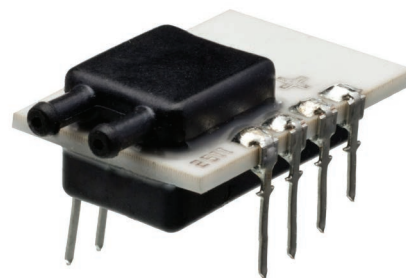

Main Features

Pressure Ranges	1, 2, 5, 10, +/-1, +/-2, +/- 5 inches of water; 2.5, 5, 12.5, 25, +/-2.5, +/- 5, +/- 12.5 mbar
Electrical Connection	PCB thru hole terminal pins, 2.54 mm [.100 inch] pitch
Pressure Connection	Barbed port, 1.9[.08] diameter
Housing Material	PPS, 40% glass filled, black
Terminal Pin Material	Phosphor bronze, tin plated
Supply Voltage	5.00 Vdc \pm 0.25 Vdc
Output Signal	Ratiometric analog; 5% to 80% of supply voltage

Attributes

- Compact Package
- Amplified Temperature Compensated Linear Output
- No Position Sensitivity Above 0-2" H₂O
- EMI/RFI and ESD Protected
- Superior Output Signal Stability
- Printed Circuit Board through Hole Mounting

Typical Applications

- Variable Air Volume Systems
- Filter Pressure Monitoring
- Duct Air Flow
- Modulated Furnace Controls
- Combustion Airflow
- Gaseous Leak Detection
- **Medical Applications:**
Oxygen Concentrators, Ventilators,
Anesthesia Equipment, CPAP,
Wound Therapy.

Description

The P1K series of pressure sensors incorporates a piezo-resistive sensing element in a compact package. Using a 5 VDC supply voltage, the P1K provides a 0.25 VDC to 4.0 VDC output proportional to pressure. Internal temperature compensation provides an accurate, easy to use sensor. The industry standard terminal pins provide ease of use for your printed circuit board designs.

Technical Specifications

Pressure Ranges

from 0 to ...	1" H2O	2" H2O	5" H2O	10" H2O	+/- 1" H2O	+/- 2" H2O	+/- 5" H2O
from 0 to ...	2.5mbar	5mbar	12.5 mbar	20 mbar	+/- 2.5 mbar	+/- 5 mbar	+/- 12.5 mbar
Proof pressure (min)	1.0 PSI/ (70mbar) (min)	1.0 PSI/ (70mbar)	1.0 PSI/ (70mbar)	1.0 PSI/ (70mbar)	1.0 PSI/ (70mbar)	1.0 PSI/ (70mbar)	1.0 PSI/ (70mbar)
Burst pressure factor	1.8 PSI/ (125mbar)	1.8 PSI/ (125mbar)	1.8 PSI/ (125mbar)	1.8 PSI/ (125mbar)	1.8 PSI/ (125mbar)	1.8 PSI/ (125mbar)	1.8 PSI/ (125mbar)

Physical

Expected Operating Life:	10 million full pressure life cycles
Shelf Life:	10 years minimum
Stability:	+/- 0.5% of full scale span for 1 year
Vibration:	10 G's peak to peak sinusoidal (20 to 1600Hz)
Shock Resistance:	50 G's ½ Sinewave, 11 mSec pulse, 18 pulses (6 per axis)
Weight:	3.5 g max.
Operating Temperature:	-20°C to 85°C
Storage Temperature:	-40°C to 125°C
Humidity:	Up to 92% RH in a non-condensing environment
Media	Dry air

Performance

Accuracy	0.25% Max (% of full scale span) (RSS of linearity, hysteresis and repeatability)
Temp. Error (0 to 60°C)	0.05%/ C [% of full scale span]
Temp. Error (-20 to 0°C and 60 to 85°C 0 to 60°C)	5% full scale span

Electrical

Output Impedance	100 Ohms max.
Excitation Current	4mA max
Minimum Load	25k Ohms between output and ground
Response Time	5 mSec max (63% full scale)

Approvals & Certificates

RoHS	
------	--

Dimensions

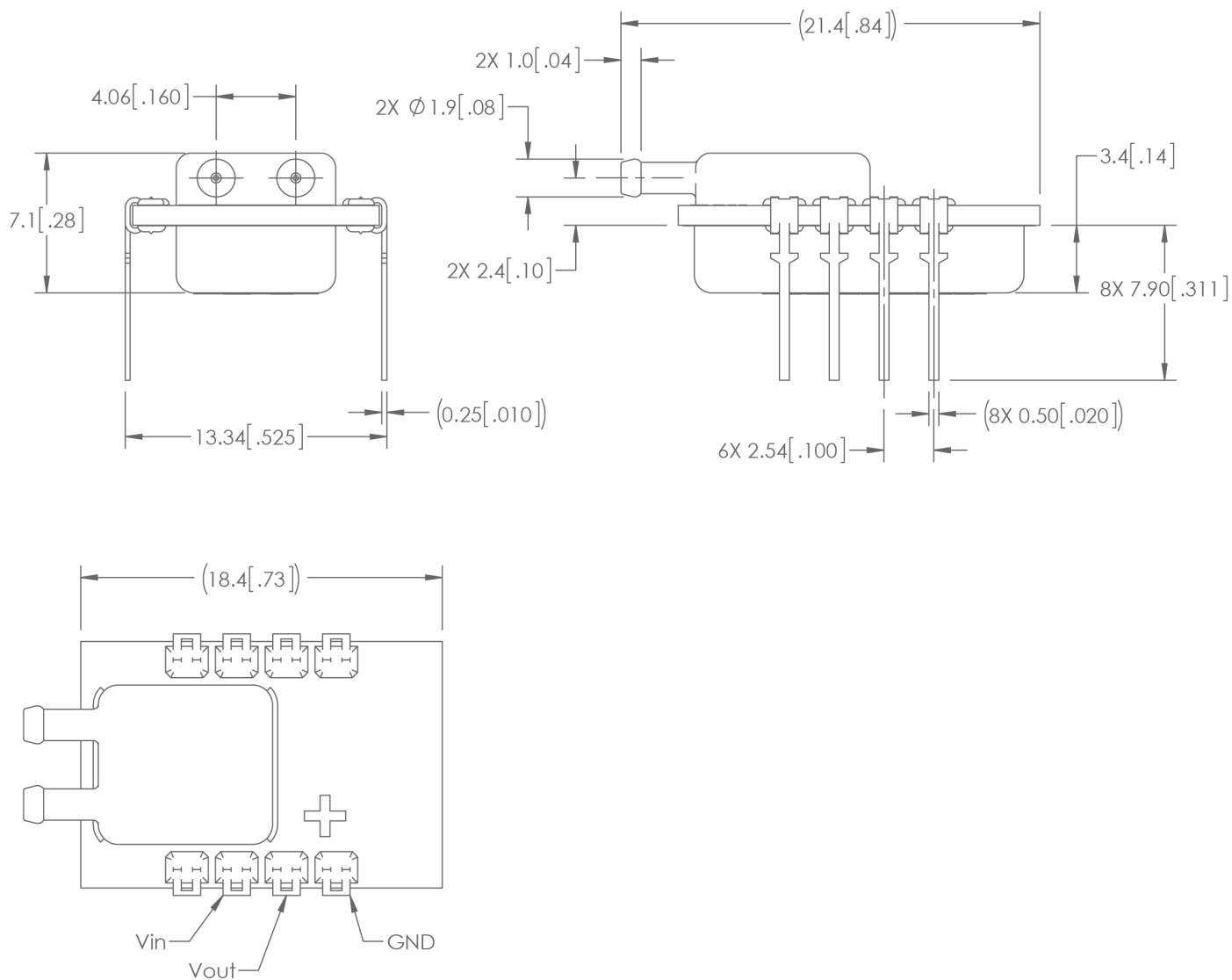

How to Order

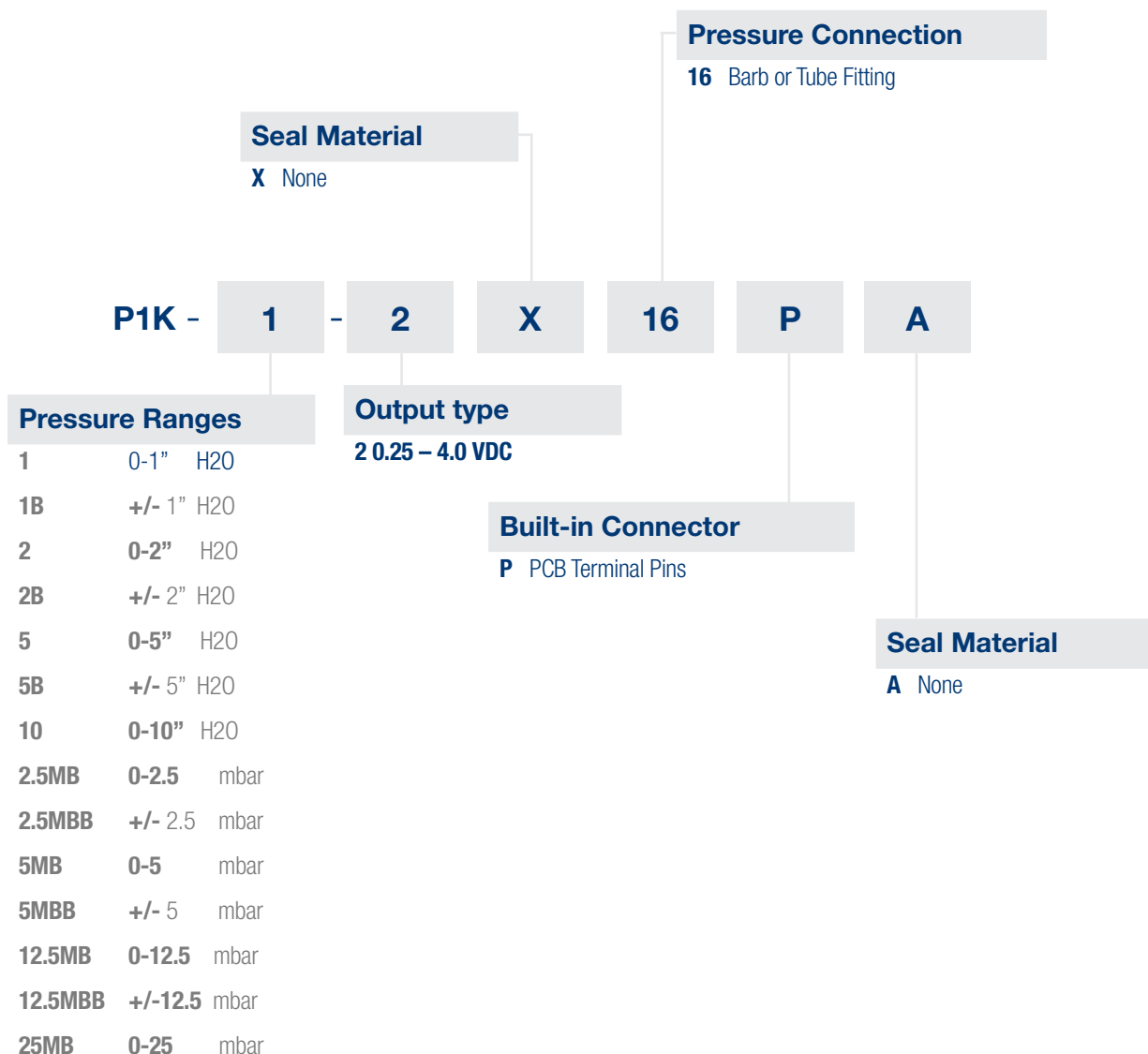

Example:

P1K-1-2X16PA

Description:

P1K Pressure sensor 0 -1" H2O, .25 to 4.0 VDC output, no internal material seal, barbed tube fitting port with PCB Terminal Pin connection, no external material seal



Before installation and operation, ensure that the appropriate pressure sensor has been selected in terms of pressure range, design and specific measuring conditions. Non-compliance can result in serious injury and/or damage to the equipment.

Warning: The product information contained in this catalogue is given purely as information and does not constitute a representation, warranty or any form of contractual commitment. Kavlico reserve the right to modify their products without notice. It is imperative that we should be consulted over any particular use or application of our products and it is the responsibility of the buyer to establish, particularly through all the appropriate tests, that the product is suitable for the use or application. Under no circumstances will our warranty apply, nor shall we be held responsible for any application (such as any modification, addition, deletion, use in conjunction with other electrical or electronic components, circuits or assemblies, or any other unsuitable material or substance) which has not been expressly agreed by us prior to the sale of our products.

- Manufacturing Facility
- Commercial Office



Contact Information

North America

Custom Sensors & Technologies (CST)
235 E. Main St., Suite 102A
Northville, MI 48167, USA
Phone: +1 (248) 465-0815
Fax: +1 (248) 465-0810
E-mail: pressure.sensors@kavlico.com

Europe

Custom Sensors & Technologies (CST)
Potsdamer Strasse 14
32423 Minden, Germany
Phone: +49 571 3859-0
Fax: +49 571 3859-119
E-mail: info@kavlico.de

China

Custom Sensors & Technologies (CST)
11th Floor, Chang Feng
International Tower, 89
Yunling Road (east), Putuo District
Shanghai - 200062, China
Phone: +86 (21) 8025 7166
Fax: +86 (21) 6107 1771
E-mail: china@cstsensors.com

India

Custom Sensors & Technologies (CST)
Trident Tower, No. 23, 4th Floor, 100 Feet Road
Ashoka Pillar Road, 2nd Block, Jaydnagar
Bangalore - 560011, India
Phone: +91 80 4113-2204/05
Fax: +91 80 4113-2206
E-mail: india@cstsensors.com

South Korea

Custom Sensors & Technologies (CST)
14F, Kbiz DMC Tower, 189,
Seongam-ro, Mapo-gu,
Seoul, Korea 121-904
Phone: +82 2 2629-8312
Fax: +82 2 2629-8310
E-mail: korea@cstsensors.com

East Asia & Pacific Countries

Custom Sensors & Technologies (CST)
10/F, Wharf T&T Centre, Harbour City,
7 Canton Road, Tsim Sha Tsui,
Kowloon, HONG KONG
Phone: +852 3960 6473
Fax: +852 3669 7111
E-mail: eap@cstsensors.com