



ALL RIGHTS RESERVED. NO PORTION OF THIS PUBLICATION, WHETHER IN WHOLE OR IN PART CAN BE REPRODUCED WITHOUT THE EXPRESS WRITTEN CONSENT OF SPC TECHNOLOGY.

SPC-F005.DWG

REVISIONS

DOC. NO. SPC-F005 * Effective: 7/8/02 * DCP No: 1398

DCP #	REV	DESCRIPTION	DRAWN	DATE	CHECKD	DATE	APPRVD	DATE
2000	A	Released	JN	07/21/09	JWM	07/21/09	JWM	07/21/09

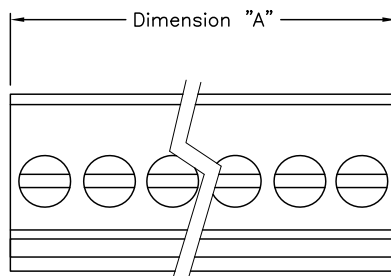

Specifications:

- Rated Voltage: AC 300V
- Rated current: 10Amp
- Wire range: 24~16 AWG
- Housing Material: Polyamide66 (UL94V-0)
- Cage Clamp: Brass, Ni plated
- Contact: Phosphor bronze, Tin plated
- Screw Size: M2.0, steel, Zinc plated
- Operating Temperature: -40°C to +105°C
- Torque: 3.0 lb-in

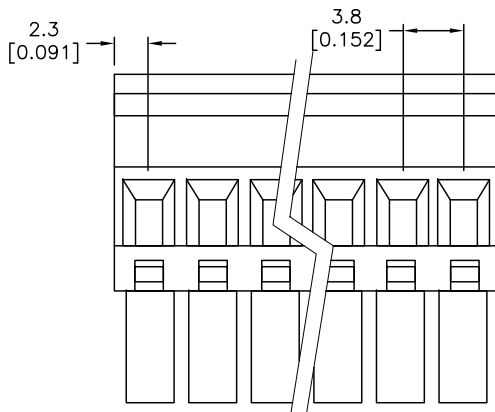
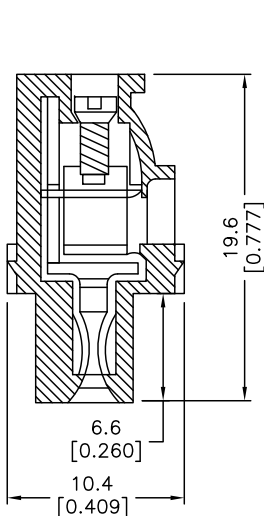

Mfg. p/n	Number of Poles	Dimension "A"
MC560-38102	2	8.4 [0.331]
MC560-38103	3	12.2 [0.481]
MC560-38104	4	16.0 [0.631]
MC560-38105	5	19.8 [0.781]
MC560-38106	6	23.7 [0.931]
MC560-38107	7	27.5 [1.081]
MC560-38108	8	31.1 [1.231]
MC560-38109	9	35.1 [1.381]
MC560-38110	10	38.9 [1.531]
MC560-38112	12	46.5 [1.831]
MC560-38115	15	57.9 [2.281]
MC560-38116	16	61.8 [2.431]

Unit of Measure: mm

DISCLAIMER:
ALL STATEMENTS AND TECHNICAL INFORMATION CONTAINED HEREIN ARE BASED UPON INFORMATION AND/OR TESTS WE BELIEVE TO BE ACCURATE AND RELIABLE. SINCE CONDITIONS OF USE ARE BEYOND OUR CONTROL, THE USER SHALL DETERMINE THE SUITABILITY OF THE PRODUCT FOR THE INTENDED USE AND ASSUME ALL RISK AND LIABILITY WHATSOEVER IN CONNECTION THEREWITH.

TOLERANCES:

UNLESS OTHERWISE SPECIFIED, DIMENSIONS ARE FOR REFERENCE PURPOSES ONLY.

DRAWN BY:	DATE:
Jason Nash	07/21/09
CHECKED BY:	DATE:
JWM	07/21/09
APPROVED BY:	DATE:
JWM	07/21/09

DRAWING TITLE:

Pluggable Terminal Block

SIZE	DWG. NO.	ELECTRONIC FILE	REV
A	Ta-1149	Ta-1149.dwg	A
SCALE:	NTS	U.O.M.: INCHES [mm]	SHEET: 1 OF 1