

FOR 15P

REMARK:

1. CHARACTERISTICS:

RATED VOLTAGE: 250V  
RATED CURRENT: 2.5AMP  
CONTACT RESISTANCE: 25mohms MAX. INITIAL, 40mohms MAX. AFTER.  
INSULATION RESISTANCE: 5000Mohms MIN. at 500V DC  
DIELECTRIC STRENGTH: 750VRMS  
OPERATING TEMPERATURE RANGE: -55° C~105° C  
INSERTION/EXTRACTION FORCE PER CONTACT: 5N Max./0.2N Min.  
MATING/UNMATING CYCLES: 200MATING MIN FOR GOLD-FLASH 500MATING MIN FOR 30u" GOLD.

2. MATERIAL:

INSULATORS: THERMOPLASTIC G.F.(UL94V-0) BLACK  
CONTACTS: COPPER ALLOY, GOLD (G/F or 30u") TOP OVER CONTACT AREA, 100u" Min MATTE TIN TOP OVER SOLDER AREA, 50u" Min NICKEL UNDER PLATE.  
SHELL: CARBON STEEL, 100u" Min NICKEL TOP OVER, 50u" Min COPPER UNDER PLATE.  
HARPOON: COPPER ALLOY, 100u" Min MATTE TIN PLATED.

3. PART NUMBER DESCRIPTION:

SERIES NO.	10090929-S	XX	X	X	LF
TYPE	S: SOCKET (FEMALE)				
NUMBER OF CONTACTS	15: 15-PIN 26: 26-PIN 44: 44-PIN 62: 62-PIN				
CONTACT FINISH	4: 100H GOLD 6: 30u" GOLD				
LF: ROHS COMPLIANT					
PLATE MOUNTING OPTION	X: UNC #4-40 CLINCHMATS L: M3 CLINCHMATS				

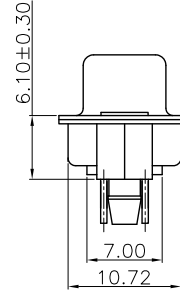

POS.	A	B	C	D	E
15	30.81	24.99	16.33	2.29	19.10
26	39.24	33.32	24.66	2.29	27.75
44	53.04	47.04	38.38	2.29	41.30
62	69.32	63.50	54.84	2.41	57.40

POS.	A	B	C	D	E
15	30.81	24.99	16.33	2.29	19.10
26	39.24	33.32	24.66	2.29	27.75
44	53.04	47.04	38.38	2.29	41.30
62	69.32	63.50	54.84	2.41	57.40

mat'l. code	tolerances unless otherwise specified
ltr	ecn no. dr date
A	109-1156 J.H 12/10/09
B	110-0164 J.H 10/19/10
linear	.X ± 0.38
	.XX ± 0.25
	.XXX ± 0.10
angles	0° ± 2°
dr	JASON HSU 10/19/10
enrg	JASON HSU 10/19/10
chr	GARY HSIEH 10/19/10
appd	JOSEPH HSIA 10/19/10
sheet index	revision sheet
	1 2 3 4 5

CUSTOMER COPY	FCI
projection	title
H/D D-SUB FEMALE STRAIGHT	
product family D-SUB	code
size dwg no	TWN
A4 10090929	sheet 1 of 5
scale 1:1	
cage code	

1 | 2

3

4

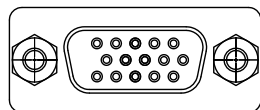
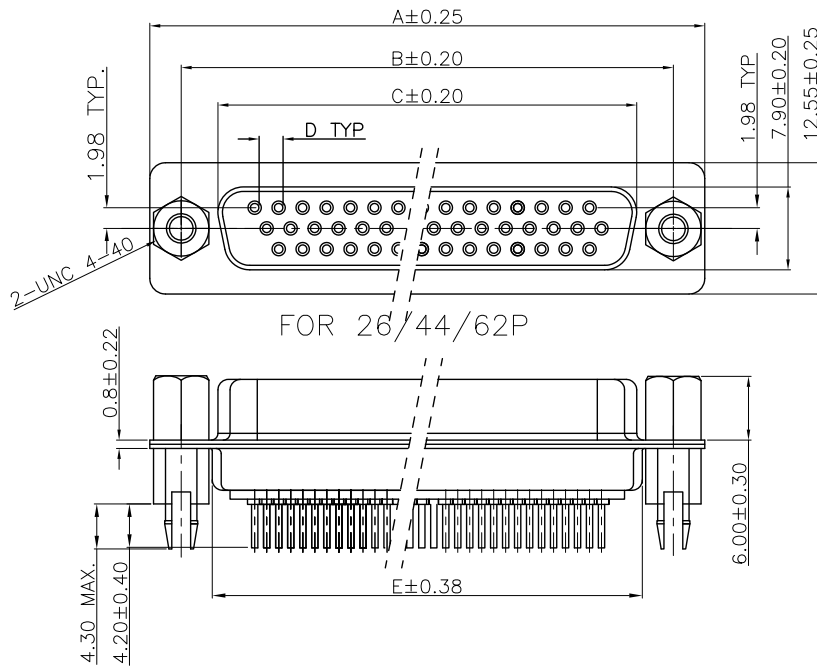

REMARK:

1. CHARACTERISTICS:

RATED VOLTAGE: 250V  
RATED CURRENT: 2.5AMP  
CONTACT RESISTANCE: 25mohms MAX. INITIAL, 40mohms MAX. AFTER.  
INSULATION RESISTANCE: 5000Mohms MIN. at 500V DC  
DIELECTRIC STRENGTH: 750VRMS  
OPERATING TEMPERATURE RANGE: -55° C~105° C  
INSERTION/EXTRACTION FORCE PER CONTACT: 5N Max./0.2N Min.  
MATING/UNMATING CYCLES: 200MATINGS MIN FOR GOLD-FLASH 500MATINGS MIN FOR 30u" GOLD.

2. MATERIAL:

INSULATORS: THERMOPLASTIC G.F.(UL94V-0) BLACK  
CONTACTS: COPPER ALLOY, GOLD(G/F or 30u") TOP OVER CONTACT AREA, 100u" Min MATTE TIN TOP OVER SOLDER AREA, 50u" Min NICKEL UNDER PLATE.  
SHELL: CARBON STEEL, 100u" Min NICKEL TOP OVER, 50u" Min COPPER UNDER PLATE.  
HARPOON: COPPER ALLOY, 100u" Min MATTE TIN PLATED.  
NUT: COPPER ALLOY, 50u" Min NICKEL PLATED.

3. PART NUMBER DESCRIPTION: 10090929-S XX X X LF

SERIES NO. \_\_\_\_\_  
TYPE \_\_\_\_\_  
S: SOCKET (FEMALE)  
NUMBER OF CONTACTS \_\_\_\_\_  
15: 15-PIN  
26: 26-PIN  
44: 44-PIN  
62: 62-PIN  
LF: ROHS COMPLIANT  
FLANGE MOUNTING OPTION  
V: UNC #4-40 SCREWS/LOCKS  
CONTACT FINISH  
A: FLASH GOLD  
B: 30u" GOLD

POS.	A	B	C	D	E
15	30.81	24.99	16.33	2.29	19.10
26	39.24	33.32	24.66	2.29	27.75
44	53.04	47.04	38.38	2.29	41.30
62	69.32	63.50	54.84	2.41	57.40

mat'l. code				tolerances unless otherwise specified		CUSTOMER COPY		FCI	
ltr	ecr no	dr	date	linear	.X ± 0.38	projection	title	www.fciconnect.com	
B					.XX ± 0.25		H/D D-SUB FEMALE STRAIGHT		
				angles	.XXX ± 0.10		product family D-SUB	code	
				dr	0° ± 2°		size dwg no	TWN	
				enrg	JASON HSU 10/19/10		A4	10090929	
				chr	GARY HSIEH 10/19/10		scale	sheet	
				appd	JOSEPH HSIA 10/19/10		1:1	2 of 5	
sheet index	revision								
	sheet								

1 | 2

3

4

ACAD

PDM: Rev:B

STATUS:Released

Printed: Nov 02, 2010

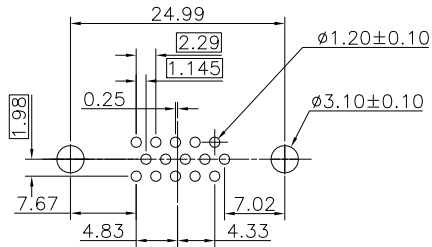

P.C.B LAYOUT(FOR 15P)

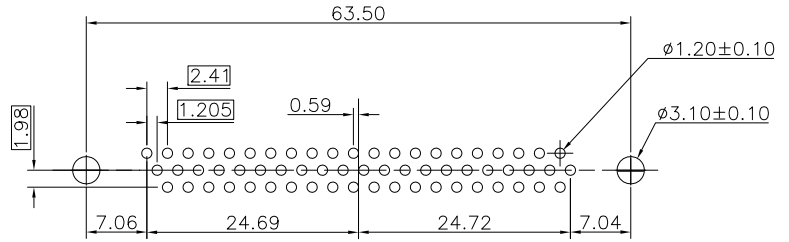

P.C.B LAYOUT(FOR 62P)

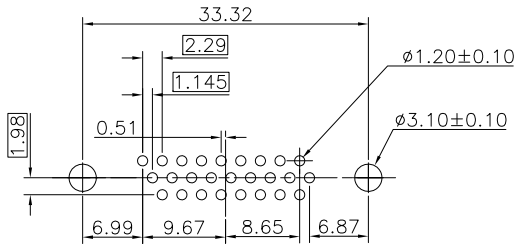

P.C.B LAYOUT(FOR 26P)

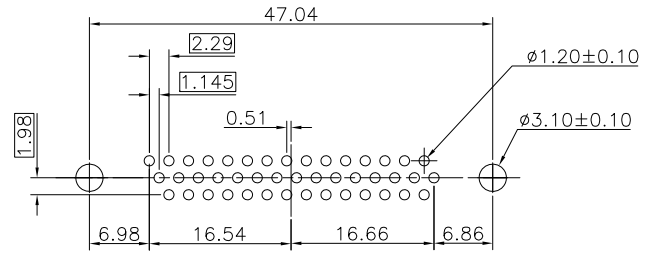

P.C.B LAYOUT(FOR 44P)

mat'l. code				tolerances unless otherwise specified		CUSTOMER COPY		FCI		www.fciconnect.com	
ltr	ecn no	dr	date	linear	.X ± 0.38	projection	title	H/D D-SUB FEMALE STRAIGHT PCB	product family	D-SUB	code
B					.XX ± 0.25						
					.XXX ± 0.10						
				angles	0° ± 2°	MM	size	dwg no	A4	10090929	sheet 3 of 5
				dr	JASON HSU 10/19/10						
				enrg	JASON HSU 10/19/10						
				chr	GARY HSIEH 10/19/10	scale	1:1				
				appd	JOSEPH HSIA 10/19/10						
sheet index	revision										
	sheet										

ACAD

PDM: Rev:B

STATUS:Released

Printed: Nov 02, 2010



1 | 2

3

4

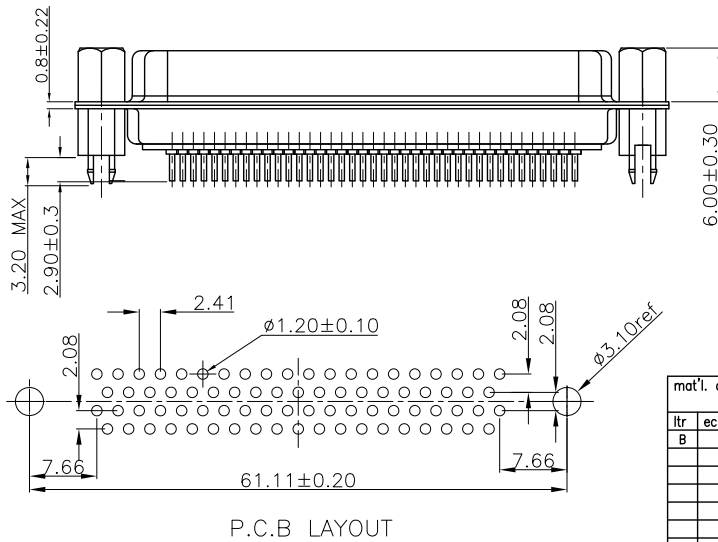
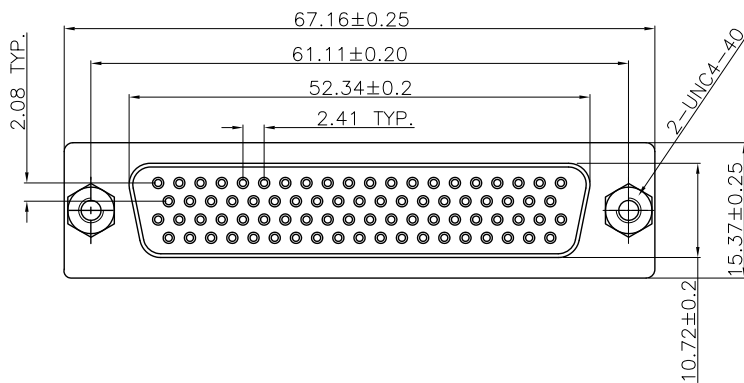

P.C.B LAYOUT

- REMARK:
- CHARACTERISTICS:
    - RATED VOLTAGE: 250V
    - RATED CURRENT: 2.5AMP
    - CONTACT RESISTANCE: 35mohms MAX. INITIAL, 50mohms MAX. AFTER.
    - INSULATION RESISTANCE: 5000Mohms MIN. at 500V DC
    - DIELECTRIC STRENGTH: 750V/RMS
    - OPERATING TEMPERATURE RANGE: -55° C~105° C
    - INSERTION/EXTRACTION FORCE PER CONTACT: 5N Max./0.2N Min.
    - MATING/UNMATING CYCLES: 200MATING MIN FOR GOLD-FLASH 500MATING MIN FOR 30u" GOLD.
  - MATERIAL:
    - INSULATORS: THERMOPLASTIC G.F (UL94V-0) BLACK
    - CONTACTS: COPPER ALLOY, GOLD(G/F or 30u") TOP OVER CONTACT AREA, 100u" Min MATTE TIN TOP OVER SOLDER AREA, 50u" Min NICKEL UNDER PLATE.
    - SHELL: CARBON STEEL, 100u" Min NICKEL TOP OVER, 50u" Min COPPER UNDER PLATE.
    - HARPOON: COPPER ALLOY, 100u" Min MATTE TIN PLATED.
    - NUT: COPPER ALLOY, 50u" Min NICKEL PLATED.
  - PART NUMBER DESCRIPTION:

10090929-S XX X X LF  
 SERIES NO. TYPE 5 SOCKET (FEMALE) NUMBER OF CONTACTS 20 79-100  
 LF: ROHS COMPLIANT  
 PLASER MOUNTING OPTION  
 V. ONE #4-40 SCREWS  
 CONTACT FINISH  
 4 100u" GOLD  
 6 30u" GOLD

PART NO.: 10090929-S78\*VLF

mat'l. code				tolerances unless otherwise specified		CUSTOMER COPY		FCI	
ltr	ecn no	dr	date	linear	.X ± 0.38	projection		title	www.fciconnect.com
B				linear	.XX ± 0.25			H/D D-SUB FEMALE STRAIGHT	
				linear	.XXX ± 0.10			product family	D-SUB
				angles	0° ±2°			size	dwg no
				dr	JASON HSU 10/19/10	MM		code	TWN
				enrg	JASON HSU 10/19/10	scale		10090929	sheet
				chr	GARY HSIEH 10/19/10	1:1		A4	5 of 5
				appd	JOSEPH HSIA 10/19/10				
sheet index	revision	sheet							

ACAD

PDM: Rev:B

STATUS:Released

cage code

Printed: Nov 02, 2010