

# SIEMENS

## Product data sheet

**3RT1054-1AP36**

CONTACTOR,  
55KW/400V/AC-3 AC(40...60HZ)/DC OPERATION UC  
220...240V AUXIL. CONTACTS 2NO+2NC 3-POLE,  
SIZE S6 WITH BOX TERMINALS CONVENTIONAL  
OPERATING MECHAN. SCREW TERMINAL

### General details:

Size of the contactor	S6
Number of poles	3

### Control circuit:

Design of activation of the operating mechanism	conventional
---	--------------

Type of voltage	AC/DC
-----------------	-------

### Control supply voltage

• at 50 Hz / for AC / rated value / minimum	220 V
• at 50 Hz / for AC / rated value / maximum	240 V
• at 60 Hz / for AC / rated value / minimum	220 V
• at 60 Hz / for AC / rated value / maximum	240 V
• for DC / rated value / minimum	220 V
• for DC / rated value / maximum	240 V

### Supply voltage frequency / for auxiliary and control current circuit / rated value

• minimum	50 Hz
• maximum	60 Hz

Design of the surge suppressor	with varistor
--------------------------------	---------------

### Main circuit:

Number of NC contacts / for main contacts	0
Number of NO contacts / for main contacts	3
Operating current	
• at AC-3 / at 400 V / rated value	115 A
• at AC-1 / at 400 V / rated value	160 A
Service power	
• at AC-3 / at 400 V / rated value	55 kW
• at AC-1 / at 400 V / rated value	92 kW
Auxiliary circuit:	
Identification number and letter for switching elements	22
Number of NO contacts / for auxiliary contact	2
Number of NC contacts / for auxiliary contact	2
Connection type:	
Design of the electrical connection / for main current circuit	screw-type terminals
Design of the electrical connection / for auxiliary and control current circuit	screw-type terminals
Mounting/fixing:	
Type of fixing/fixation	screw fixing
Series installation	Yes

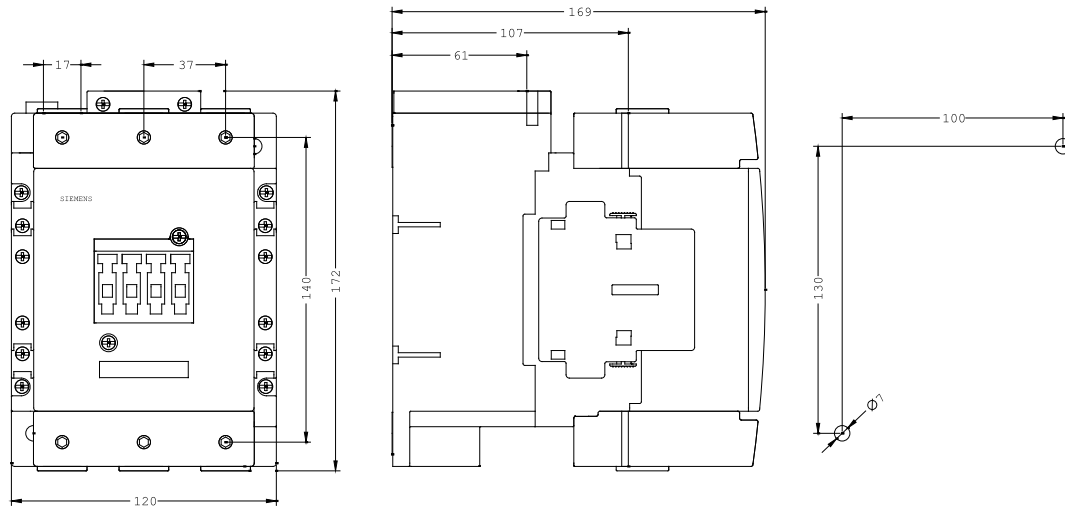

last change:

10/31/2006

**Technical Assistance:**

Telephone: +49 (0) 911-895-5900 (8<sup>00</sup> - 17<sup>00</sup> CET)

Fax: +49 (0) 911-895-5907

E-Mail: [technical-assistance@siemens.com](mailto:technical-assistance@siemens.com)

Internet: [www.siemens.de/lowvoltage/technical-assistance](http://www.siemens.de/lowvoltage/technical-assistance)