

# MAXIMUM SOLUTIONS

## Mill-Max Introduces Fine Pitch SMT Gull Wing Connector Series

*1mm Pitch, Low Profile Makes Components Well Suited For  
Compact Designs with Limited PCB Space*

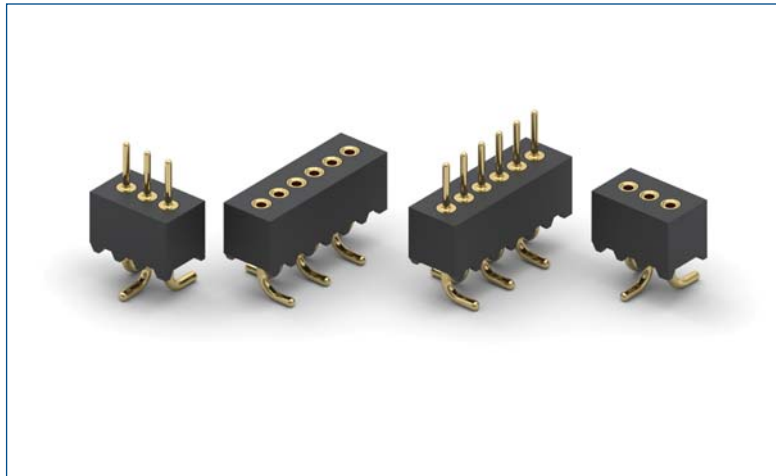

Mill-Max Mfg. Corp. announces the availability of its new fine pitch SMT gull wing connector series. The series comprises the 860-10-0XX-30-002000 (1mm gull wing SMT header available in 3 - 26 positions) and the 861-13-0XX-30-002000 (1mm gull wing SMT socket available in 3 - 26 positions).

With a board-to-board stack height measuring less than 0.3" (7,62mm), the Mill-Max gull wing series is ideal for tight, compact spaces in which a surface mount, precision-machined connector is the preferred design choice. In addition, the diameter of the leads – .014" (0,36mm) for the socket, .015" (0,38mm) for the header – leaves a tiny footprint, saving valuable PCB space.

Sockets feature gold-plated shells and contacts, and headers gold-plated pins, thus ensuring optimum conductivity and superior wear resistance. The gull wing design allows for more effective and efficient inspection of the solder joints.

Additional features of the Mill-Max fine pitch SMT gull wing connector series:

- RoHS compliant
- Equipped with high temperature insulators and suitable for RoHS soldering processes
- Socket end uses a low-insertion force contact inside receptacles
- Gas tight connection when mated
- Coplanarity of 0.005" (0,13mm).

All Mill-Max pin headers and receptacle sockets feature high-speed, screw-machined pins and receptacles manufactured to precision tolerances. Inside each 861 series receptacle is a precision stamped Beryllium Copper Mill-Max #04 3-finger contact clip with a pin acceptance range of .008"-.013" (0,2mm – 0,33mm) diameter and a current rating of 2 amps.

For more information, go to [www.mill-max.com/PR643](http://www.mill-max.com/PR643).

(10/13 -- PR643)

**Mill-Max Mfg. Corp. • 190 Pine Hollow Road, Oyster Bay, NY 11771**  
**516-922-6000 • Fax: 516-922-9253 • [www.mill-max.com](http://www.mill-max.com)**



# INTERCONNECTS

## SERIES 860 & 861 • 1mm GRID SURFACE MOUNT GULL WING HEADERS & SOCKETS • SINGLE ROW STRIPS

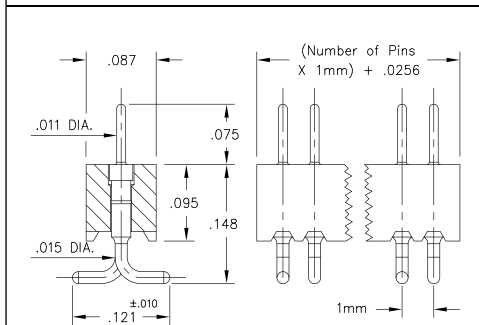
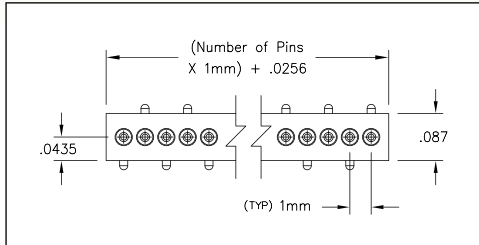

Coplanarity .005". For pin counts >20 positions, consult Technical Support.

**FIG. 1**

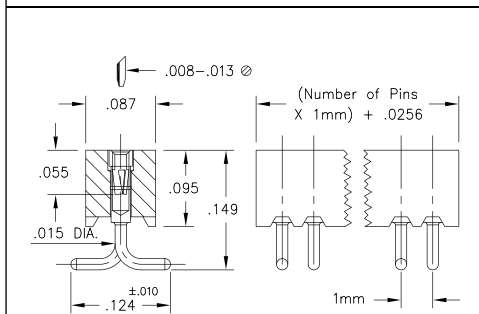

Coplanarity .005". For pin counts >20 positions, consult Technical Support.

**FIG. 2**

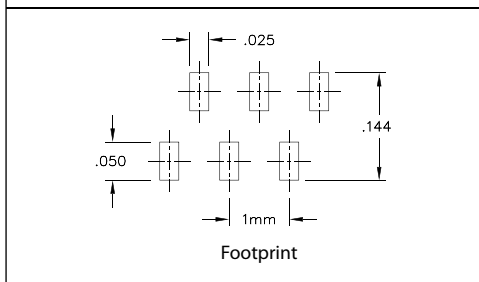

- Series 860 surface mount gull wing headers have .011" dia. pluggable pins for Surface Mount soldering to the P.C.B. (MM #3039). See page 208 for details
- Series 861 surface mount gull wing sockets uses MM #0439 receptacles that accept pin diameters from .008"-.013". See page 156 for details
- Receptacles use Hi-Rel, 3-finger BeCu #04 contact rated at 2 amps. See page 250 for details
- Insulators are high temperature thermoplastic, suitable for all soldering operations

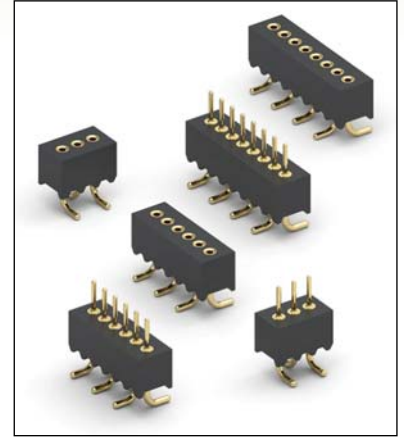

### ORDERING INFORMATION

FIG. 1	Series 860...002 Single Row Surface Mount Header	
	860-10-0-30-002000	
	Specify number of pins	03-26
<div>RoHS-2 2011/65/EU</div> <div>XX=Plating Code See Below</div> <div>For Electrical, Mechanical &amp; Environmental Data, See page 264</div>		
SPECIFY PLATING CODE XX=		
Pin Plating		
10 10 μ" Au		

FIG. 2	Series 861...002 Single Row Surface Mount Socket	
	861-13-0-30-002000	
	Specify number of pins	03-26
<div>RoHS-2 2011/65/EU</div> <div>XX=Plating Code See Below</div> <div>For Electrical, Mechanical &amp; Environmental Data, See page 264</div>		
SPECIFY PLATING CODE XX=		
Sleeve (Pin)		
Contact (Clip)		
13 10 μ" Au 30 μ" Au		



# Mouser Electronics

Authorized Distributor

Click to View Pricing, Inventory, Delivery & Lifecycle Information:

Mill-Max:

[860-10-020-30-002000](#) [861-13-020-30-002000](#) [861-13-002-10-002000](#) [861-13-012-10-002000](#)