

## Housing - HC-HPR-B06-HHWH-1TTM25-EM-BK - 1411106

Please be informed that the data shown in this PDF Document is generated from our Online Catalog. Please find the complete data in the user's documentation. Our General Terms of Use for Downloads are valid (<http://phoenixcontact.com/download>)



HEAVYCON B6 sleeve housing, HPR series, with screw locking, with M32 thread, straight outlet, for increased environmental and EMC requirements



### Key commercial data

Packing unit	1 pc
GTIN	 4 046356 921404
Weight per Piece (excluding packing)	22.22 g
Custom tariff number	85389099
Country of origin	China

### Technical data

#### Dimensions

Height	100.5 mm
Width	58 mm
Length	132 mm

#### Ambient conditions

Degree of protection of housing (IP)	IP68 (0.5 bar, 24 h)
	IP69K
Ambient temperature (operation)	-40 °C ... 125 °C

#### General

Note	For contact inserts HC-B6, BB10, DD24, M Tall housings for extra large wiring space
Type	B6
Housing type	Sleeve housing
Locking type	with screw locking
No. of cable outlets	1
Cable exit	Straight
Screw connection	none

## Housing - HC-HPR-B06-HHWH-1TTM25-EM-BK - 1411106

### Technical data

#### General

Type of the screw connection	1x M25
Protective cover	No
Housing material	Aluminum die-cast
Housing surface material	Powder-coated, black
Material lock	High-grade steel
Material of locking screw	High-grade steel
Assembly instructions	Locking screw: slotted hexagon head screw (SW10)

### Classifications

#### eCl@ss

eCl@ss 5.1	27143424
eCl@ss 6.0	27261203
eCl@ss 8.0	27440202

#### ETIM

ETIM 4.0	EC000437
ETIM 5.0	EC000437

### Approvals

#### Approvals

#### Approvals

#### EAC / GL

#### Ex Approvals

#### Approvals submitted

#### Approval details

EAC
-----

GL
----

### Accessories

#### Accessories

## Housing - HC-HPR-B06-HHWH-1TTM25-EM-BK - 1411106

### Accessories

#### Extension adapter

Extension adapter - ENLAR-M-KV-M25/M32 - 1647679



Step-up adapter, M25 to M32, including O-ring

---

#### Full screw connection

Cable gland - G-INS-M25-M68N-PNES-GY - 1411126



Cable gland, Cable gland material: Polyamide 6, External cable diameter 11 mm ... 17 mm, Shielding: No, Connecting thread: M25, Color: silver grey

---

Cable gland - G-INS-M25-M68N-PNES-BK - 1411134



Cable gland, Cable gland material: Polyamide 6, External cable diameter 11 mm ... 17 mm, Shielding: No, Connecting thread: M25, Color: jet black

---

Cable gland - G-INS-M25-M68N-NNES-S - 1411165



Cable gland, Cable gland material: Brass, nickel-plated, External cable diameter 11 mm ... 17 mm, Shielding: No, Connecting thread: M25, Color: silver

---

Cable gland - HC-M-KV-M25(14-21) - 1646007



Metal screw connection up to 5 bar, thread length: 7 mm, cable diameter: 14 - 21 mm, WAF 34, screw connection: M25

## Housing - HC-HPR-B06-HHWH-1TTM25-EM-BK - 1411106

### Accessories

Cable gland - G-INSEC-M25-S68N-NCRS-S - 1411190



Cable gland, Cable gland material: Brass, nickel-plated, External cable diameter 11 mm ... 16 mm, Shielding: Yes, Connecting thread: M25, Color: silver

---

Cable gland - HC-M-KV-Z-M25 - 1646159



Metal screw connection with strain relief clamp, thread length: 7 mm, cable sealing area: 10 - 19 mm, clamping area: 12 - 22 mm, SW 30, screw connection: M25

---

Cable gland - HC-M-KV-T-M25 - 1646191



Metal screw connection with cable bend protection and strain relief, thread length: 7 mm, cable sealing area: 10 - 19 mm, clamping area: 14 - 21 mm, SW 30, screw connection: M25

---

Plug for cable screw gland

Filler plugs - HC-M-BS-M25 - 1645859



Filler plug, metal, size: M25

---

Reducing adapter

Reducing adapter - REDUC-M-KV-M25/M20 - 1647624



Step-down adapter, M25 to M20, including O-ring

---

### Drawings

## Housing - HC-HPR-B06-HHWH-1TTM25-EM-BK - 1411106

Dimensioned drawing

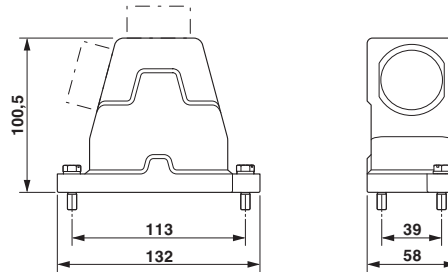

Dimensional drawing