

Distributed by:

**JAMECO**<sup>®</sup>  
ELECTRONICS

**www.Jameco.com ♦ 1-800-831-4242**

The content and copyrights of the attached  
material are the property of its owner.

Jameco Part Number 744202

THIS DRAWING IS UNPUBLISHED. RELEASED FOR PUBLICATION .19 .  
© COPYRIGHT 19 BY AMP INCORPORATED. ALL INTERNATIONAL RIGHTS RESERVED.

LOC	DIST	P	F	REVISIONS				
				ZONE	LTR	DESCRIPTION	DATE	APPD
BD	39	B	✓		B	REV & REDRAWN ECNS-2261 & 2262	-	-

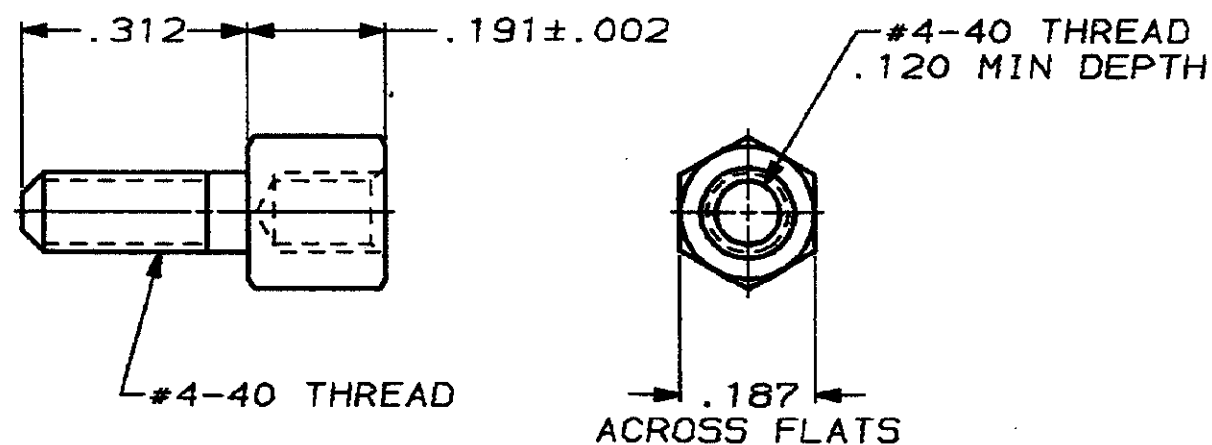

- 1 ZINC PLATED PER ASTM B633, TYPE II, CLASS SC1, YELLOW CHROMATE.  
2 ZINC PLATED PER ASTM B633, TYPE III, CLASS SC1, CLEAR CHROMATE.

2	205818-3
1	205818-2
FINISH	PART NO

DO NOT SCALE PRINT. UNLESS SPECIFIED DIMENSIONS IN INCHES TOLERANCES ON: 2 PLC DEC ± - 3 PLC DEC ± .005 ANGLES ± -		DR: <i>Richard 5-23-88</i> CHK: <i>W. Wilson 5-23-88</i> APPD: <i>R. Whyne 5-24-88</i> APPD: <i>V. K. May 5/24/88</i>		AMP   AMP INCORPORATED Harrisburg, Pa. 17105	
MATERIAL COLD ROLLED STEEL PER ASTM A108		NAME SCREWLOCK, FEMALE, AMPLIMITE®		DRAWING NO 205818	
FINISH SEE TABLE		SIZE B		FSCM NO 00779	
		APPLICATION SPEC -		SCALE 4:1	
		WEIGHT -		SHEET 1 OF 1	