

DIN Rails *DR Series*



- Field installable.
- Includes a set of 3 plated rails.
- Available in 3 industry standard profiles - DIN 1, DIN 3, and CENELEC.
- DIN rail mounting kit required for installation.
- Rails have a 0.28 x 1.25 oblong slot on each end.
- Zinc plated.

Accessories

- DIN Rail Mounting Kit

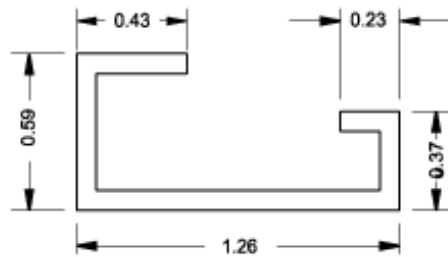

Asymmetric DIN 1 Pro

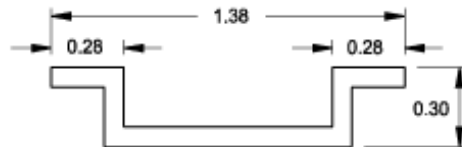

Symmetric DIN 3 Pro

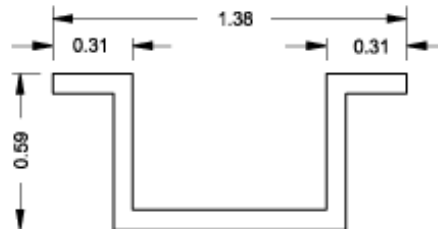

CENELEC Pro

Asymmetric DIN 1 Profile	Symmetric DIN 3 Profile	Cenelec Profile	
Part No.	Part No.	Part No.	Length
2D1K12	2D2K12	2DCK12	9.25
2D1K16	2D2K16	2DCK16	13.25
2D1K20	2D2K20	2DCK20	17.25
2D1K24	2D2K24	2DCK24	21.25

AsymmetricDIN 1	Symmetric DIN 3	Cenelec	
Profile	Profile	Profile	
Part No.	Part No.	Part No.	Length
2D1K30	2D2K30	2DCK30	27.25

Data subject to change without notice

© 2017. Hammond Manufacturing Ltd. All rights reserved.

Mouser Electronics

Authorized Distributor

Click to View Pricing, Inventory, Delivery & Lifecycle Information:

[Hammond:](#)

[2DCK24](#) [2DCK16](#) [2DCK12](#) [2DCK20](#) [2DCK30](#) [2D2K12](#) [2D2K30](#) [2D2K16](#) [2D1K16](#) [2D1K30](#) [2D1K12](#) [2D1K20](#)
[2D1K24](#) [2D2K24](#) [2D2K20](#)