

EAO – Your Expert Partner for Human Machine Interfaces

45-2234.31E0.000 - Illuminated pushbutton actuator, Maintain

45-2234.31E0.000 - Illuminated pushbutton actuator, Maintain

Attention: The preview is based on a sample product. This can differ from your current configuration.

Mounting

Design	raised
Mounting cut-out	∅ 22.5 mm

Front

Front shape	round
Front dimension	Ø 29.45 mm
Front ring material	Metal mat
Front ring colour	sandgrey

Other Attributes

Weight	0.020 kg
--------	----------

Operating-/Indication part

Lens optics	opaque
Lens material	Plastic
Lens colour	red transparent
Lens profile	flat / level with front ring

IP-Rating

Front protection	IP66, IP67, IP69K
------------------	-------------------

Actuator

Switching action	Maintained
Housing material	Plastic

Switching element

6

Function

Illuminated pushbutton

EAO – Your Expert Partner for Human Machine Interfaces

45-2234.31E0.000 - Illuminated pushbutton actuator, Maintain

Dimensions

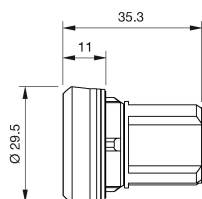

Mounting cut-outs

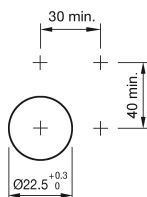

Wiring diagram



Additional information

Push to unlatch

Legend

Switching action: C = Maintained