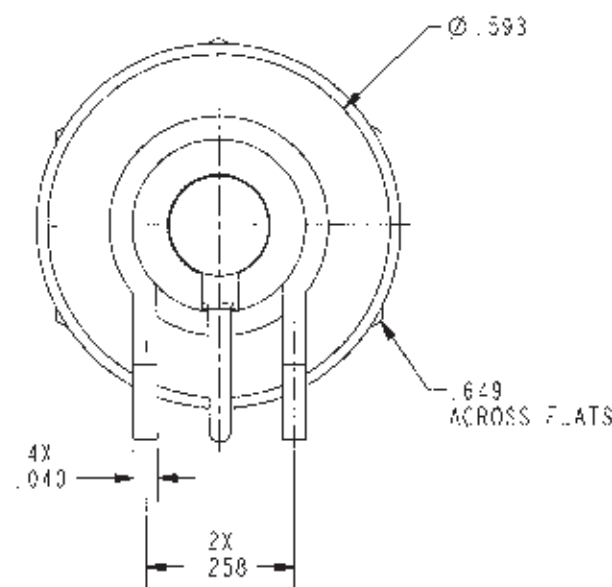
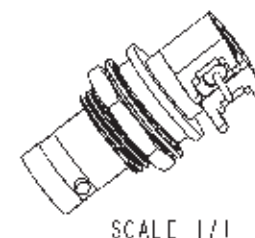
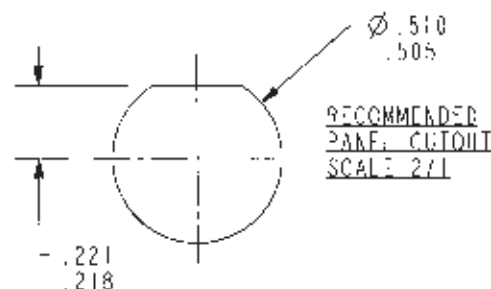

DATA CONTAINED IN THIS DOCUMENT IS  
PROPRIETARY TO FORMERLY SSGROS CS INC  
AND SHALL NOT BE REPRODUCED, COPIED OR USE  
FOR PROGRAM OR ANALYSIS WITHOUT  
EXPRESS WRITTEN PERMISSION

[illegible]

- SHOWN

## RED WORMS ON THE MOVE

1. ROLLS 6 COMPLIANT 50 & 75  $\Omega$  7 GBT ANGLE CIRCUIT BOARD AND BULKHEAD MOUNTING BNC RECEPTACLE

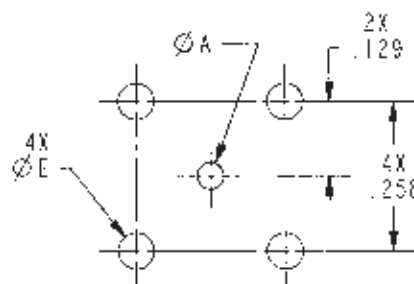

RECOMMENDED  
MIG WELD PATTERN  
SCALE 3/1

NOTES: UNLESS OTHERWISE SPECIFIED.

NEXT ASSY

INTERPRET DRAWING PER VIL-STD-100. DIMENSIONS ARE IN INCHES AND INCLUDE FINISH THICKNESS UNLESS OTHERWISE SPECIF. CO.	
DRW H. JOHNSON	5-15-00
CHG J. M.	6-13-00
REND?	...
APPROVED	...

TOL. UNLESS SPECIFIED		
.XX	±	.02
.XXX	±	.013
MMGF	±	1°

4476141

Enriched

PROFE STYLE NO.	6.0001
-----------------	--------

DO NOT SCALE DRAW



**TROMPETER**  
RF connectivity  
a cinch connectivity solutions brand

Part	RoHS 6 COMPLIANT J7CDBJR297A TYPE CONNECTOR ASSEMBLY
------	--

SIZE	CASE CODE	DRAWING NO.
A	14949	6-000

SCALE 3:1 DATE 13.06 SHEET 10

# Mouser Electronics

Authorized Distributor

Click to View Pricing, Inventory, Delivery & Lifecycle Information:

[Cinch Connectivity Solutions:](#)

[CBBJR29A](#)