

DETAILS

Product Number	CN12927_LENA-M
Family	Lena
Type	RefPack
Color	metal
Diameter	111 mm
Height	86,5 mm
Style	round
Optic Material	
Holder Material	
Fastening	screw, socket
Status	production ready
ROHS Compliant	Yes
Date Updated	23/02/2014

OPTICAL PROPERTIES

LED	Viewing Angle	Light Beam	Effi- ciency	cd/lm	Connector
LUXEON K16	20 deg	Medium	77 %	0.460	-
LUXEON K12	19 deg	Medium	80 %	0.530	-



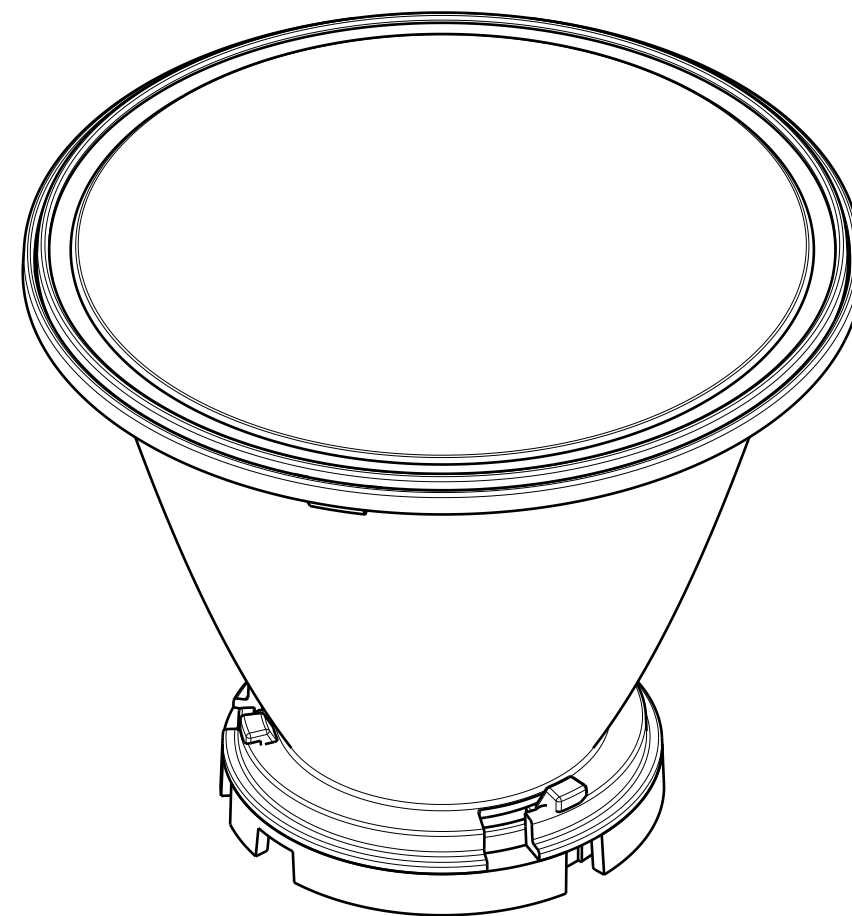
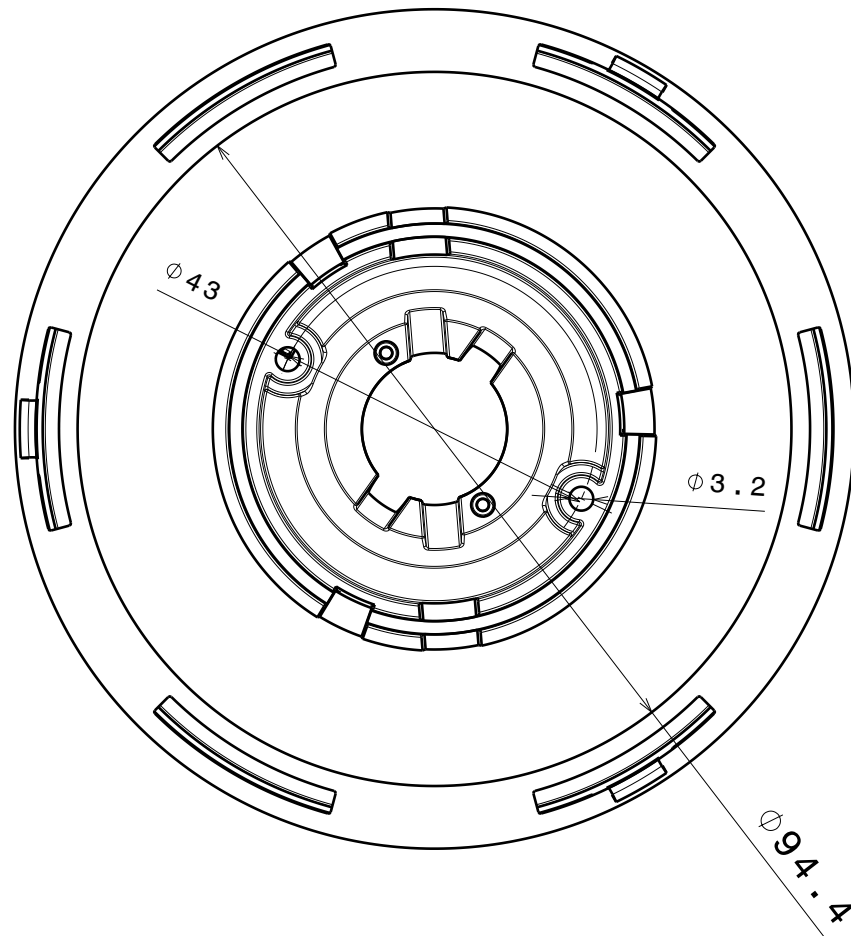
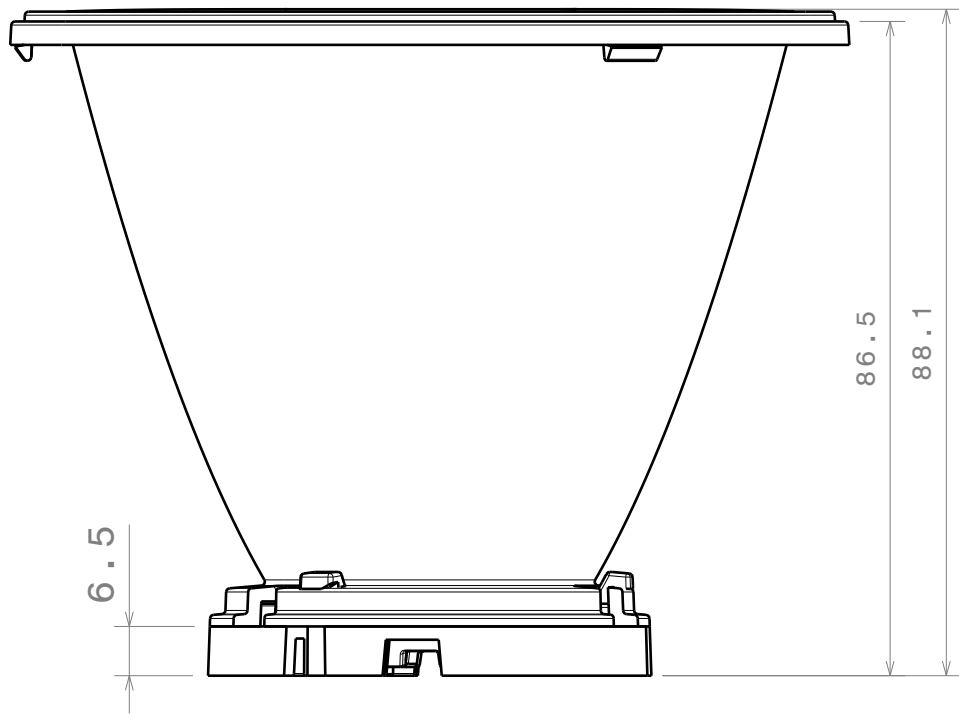

Isometric view

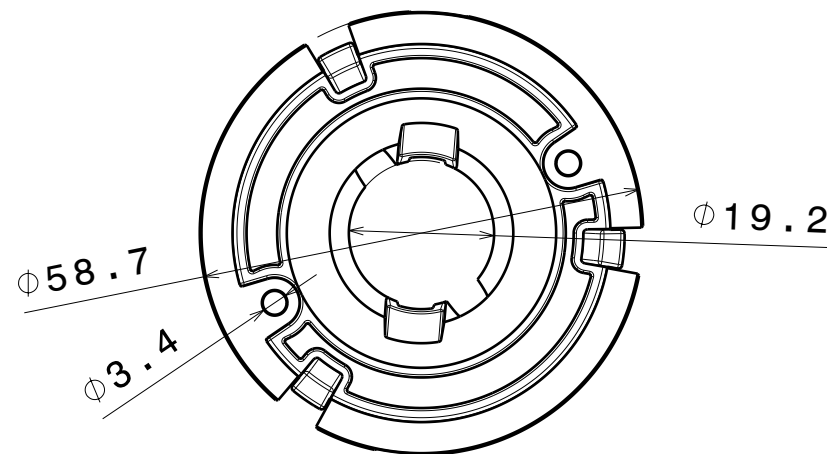
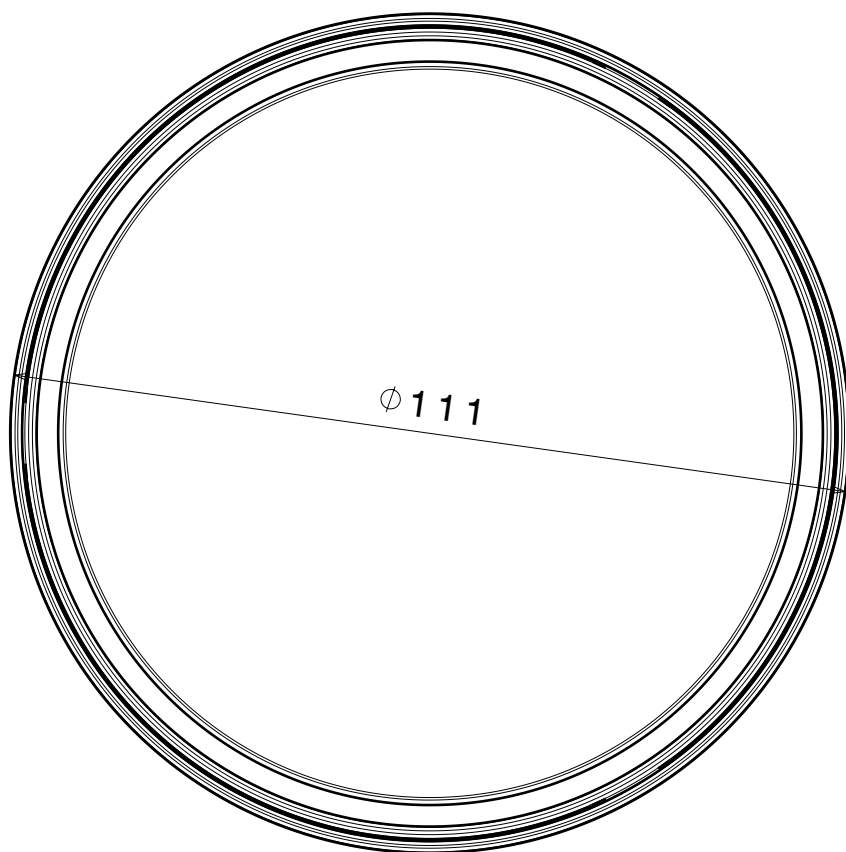

Material:

subLens
- PC

Reflector
- PC
- Metal coating and clear lacquer

Holder base
- PC
- Color white

Base part designed for
Philips Lumileds LUXEON K, 12up and 16up versions

This drawing is our property.
It can't be reproduced
or communicated without
our written agreement.



Ledil Oy
Salorankatu 10
FIN 24240 SALO
Finland

DRAWN BY	DATE
as	3.8.2012
CHECKED BY	DATE
VS	3.8.2012
DESIGNED BY	DATE
p1	-

DRAWING TITLE		Part Drawing	
LENA-LUXEON-K Mechanical drawing			
SIZE	PART NUMBER	REV	
A3		001	
SCALE	1:1	WEIGHT	SHEET 1/1

Luminaire: LEDiL Oy CN12927_LENA-M_(Luxeon_K16) Eff.77.2%
Lamps: 1 x Luxeon_K16 (1208.05lm@250mA)

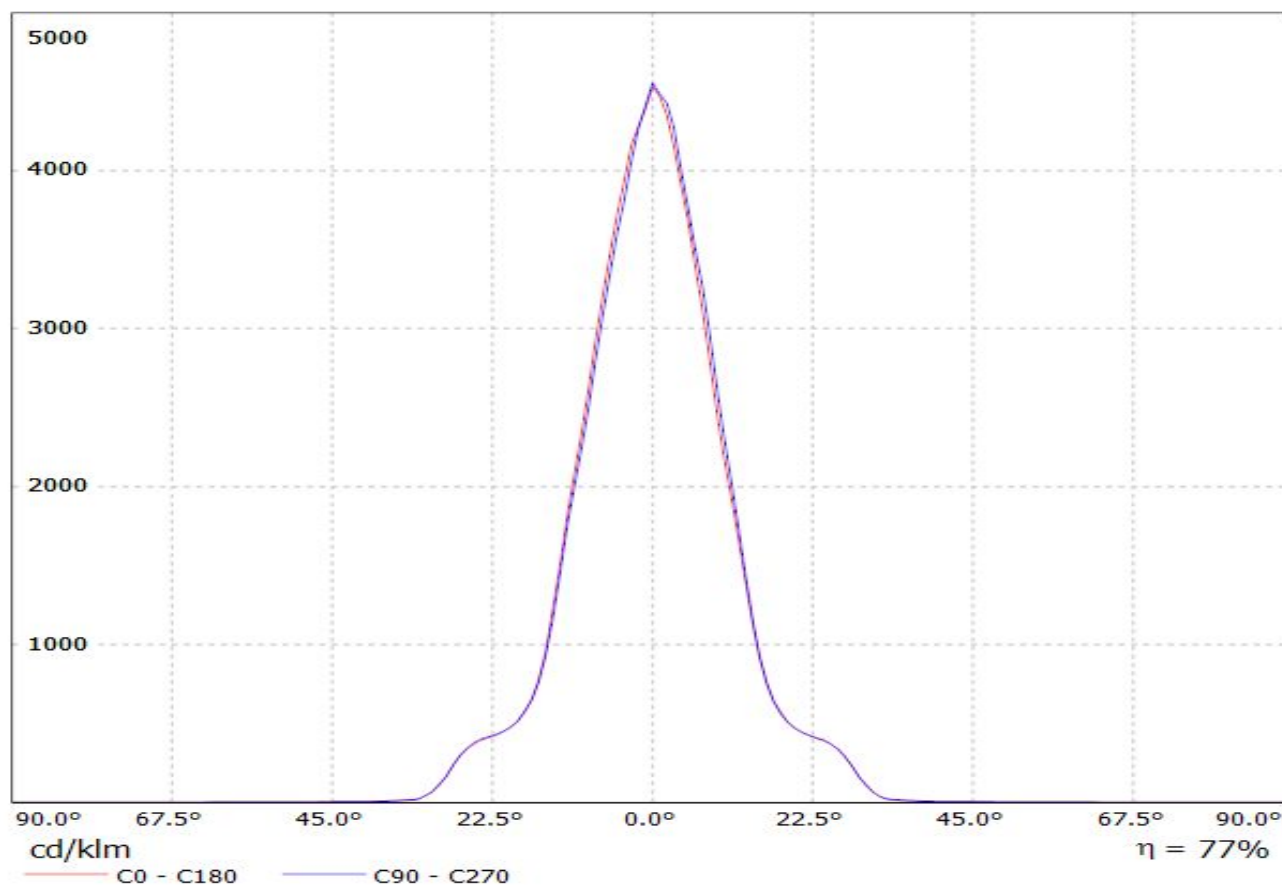

Luminaire: LEDiL Oy CN12927_LENA-M_(Luxeon_K12) Eff.79.7%
Lamps: 1 x Luxeon K12 (808.51lm@250mA)

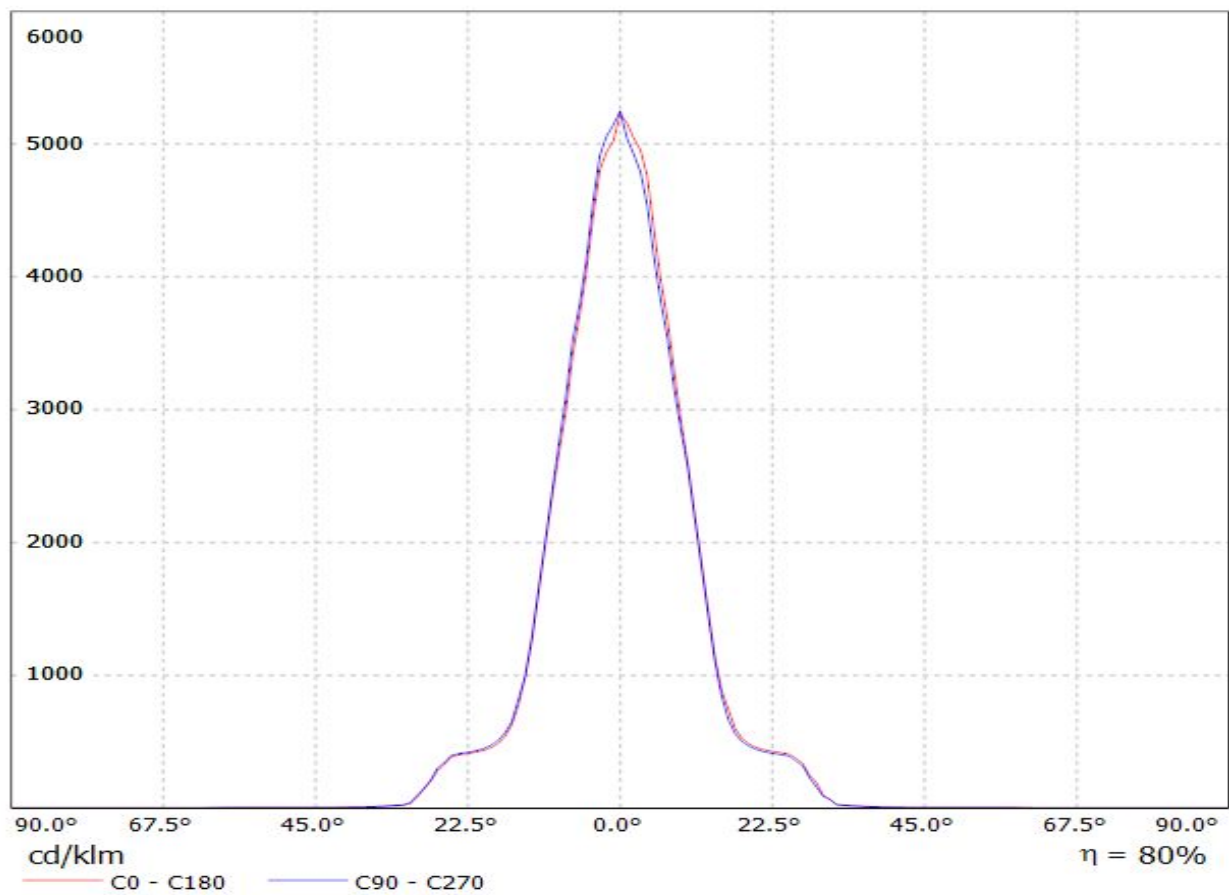

Luminaire: LEDiL Oy CN12927_LENA-M_(Luxeon_K16) Eff.77.2%
Lamps: 1 x Luxeon_K16 (1208.05lm@250mA)

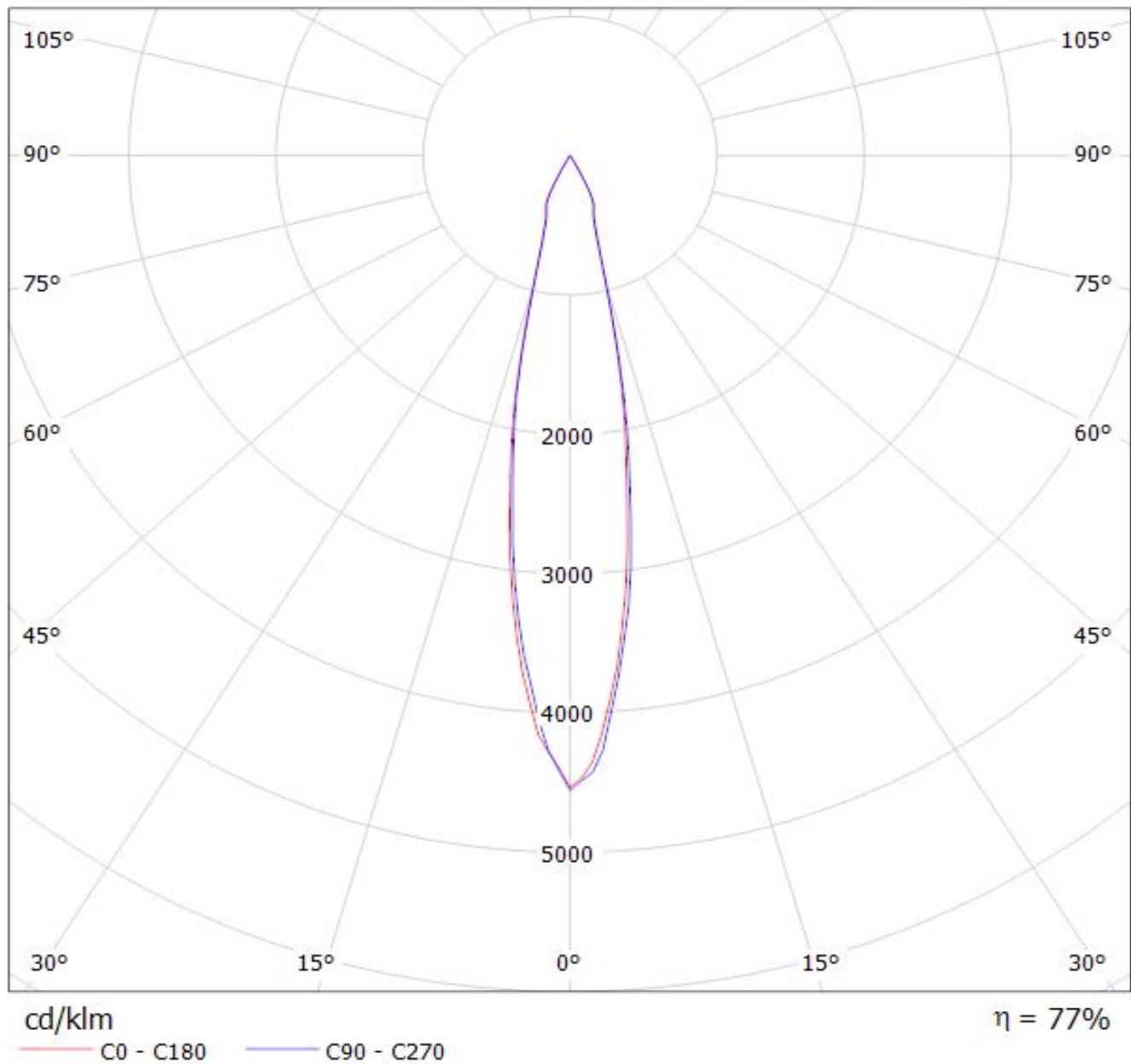

Luminaire: LEDiL Oy CN12927_LENA-M_(Luxeon_K12) Eff.79.7%
Lamps: 1 x Luxeon K12 (808.5lm@250mA)

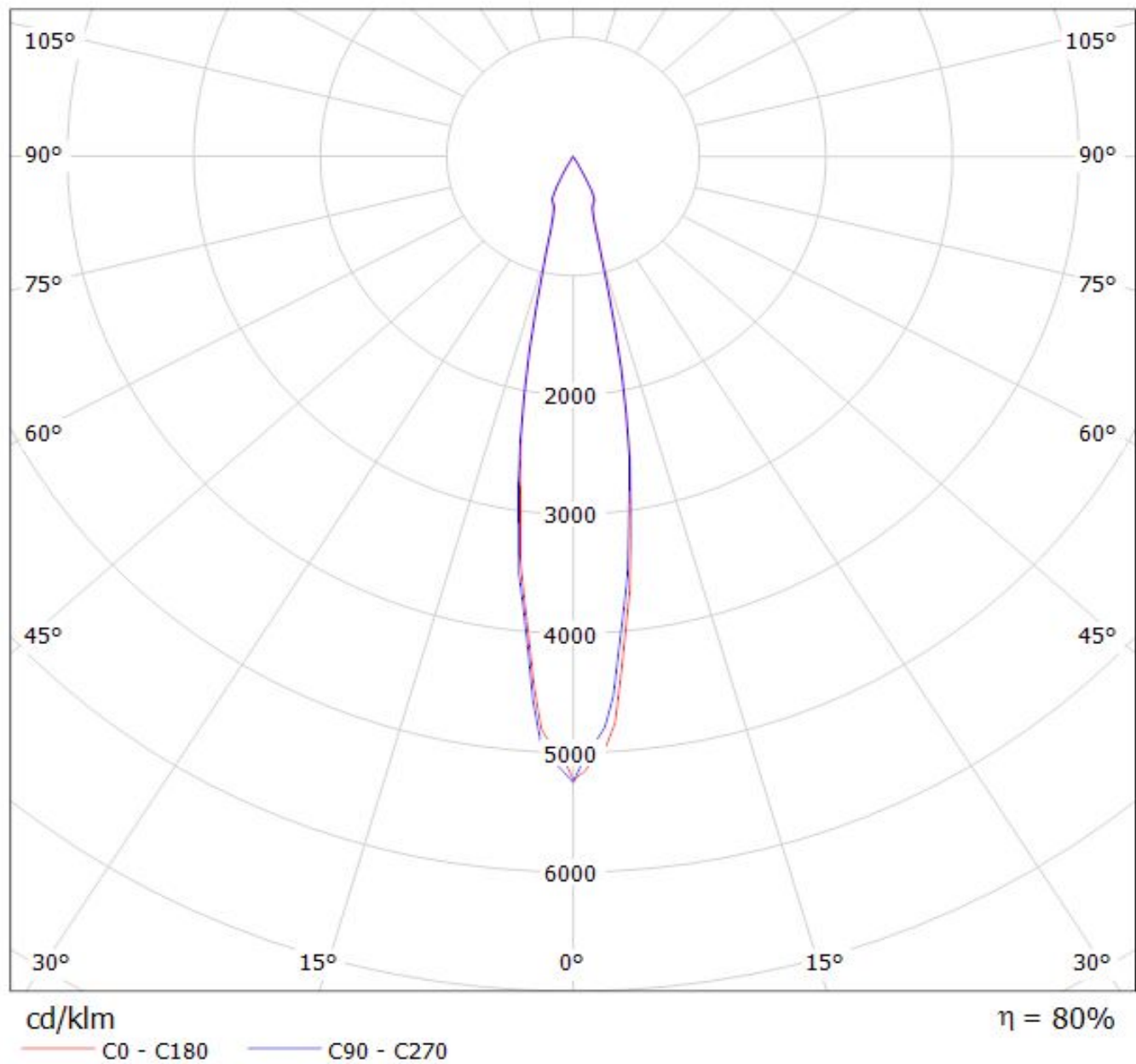

NOTE: The typical divergence will be changed by different color, chip size and chip position tolerance. The typical total divergence is the full angle measured where the luminous intensity is half of the peak value.