



8		7	
THIS DRAWING IS UNPUBLISHED.		RELEASED FOR PUBLICATION	
20		20	
(C) COPYRIGHT 20		BY TYCO ELECTRONICS CORPORATION, ALL RIGHTS RESERVED.	
PART NUMBER	REV	DESCRIPTION	PROGRAMMED MEMORY CHIP
1911214-1	A	CUTS CARRIER	8-1911214-1
1911214-6	A	CONTINUOUS CARRIER	8-1911214-6
7-1911214-1	A	-1 AND SPARE PARTS	9-1911214-1
7-1911214-6	A	-6 AND SPARE PARTS	9-1911214-6
7-1911214-7	A	SPARE PARTS KIT	-

APPLICATOR DATA		
CRIMP	SIZE	TYPE
WIRE	1.22mm [.048]	F
INSUL	2.03mm [.080]	F
APPL INSTRUCTIONS 408-10135		

TERMINAL DATA: TE TERMINAL		TYCO ELECTRONICS CRIMP SPEC	
TERMINAL NAME: MINI UNIV MATE-N-LOK PIN CONTACT			
WIRE STRIP LENGTH 3.2-4.0 mm [.125-.157 IN]		INSULATION DIAMETER RANGE 1.20-1.75mm [.047-.068 IN]	
			
TERMINAL	114-5050 (A)	114-1111 (C)	-
APPL SPEC	 114-16017 (B)	-	-

TERMINALS APPLIED			
170359-1 (A)	170359-2 (A)	170359-3 (A)	170359-4 (A)
1-170359-2 (A)	1-170359-3 (A)	170361-1 (A)	170361-2 (A)
170361-3 (A)	170361-4 (A)	170361-5 (A)	170361-6 (A)
1-170361-3 (A)	770901-1 (B)	770901-2 (B)	770901-3 (B)
1-770901-0 (B)	794218-1 (C)	794218-2 (C)	794218-3 (C)
1-794218-0 (C)	770902-1 (B)	770902-2 (B)	770902-3 (B)
770902-4 (B)	770902-5 (B)	770902-6 (B)	1-770902-0 (B)
1-770902-1 (B)	794219-1 (C)	794219-2 (C)	794219-3 (C)
1-794219-0 (C)	-	-	-

WIRE SIZE	CRIMP HEIGHT
22AWG or 0.34mm ²	.78±.05 [.031±.002]
24AWG or 0.22mm ²	.69±.05 [.027±.002]
26AWG or 0.14mm ²	.63±.05 [.025±.002]

- RECOMMENDED SPARE PARTS.
- GREASE BEARING SURFACES LIGHTLY.
3. LUBRICATE DAILY PER THE APPLICATOR INSTRUCTION SHEET SUPPLIED WITH THE APPLICATOR.
- ITEM 19 - OPTIONAL STRIPPER FOR BENCH MACHINE APPLICATIONS.
- APPLICATOR SPECIFIC DATA TO BE ENTERED INTO BLANK MEMORY CHIP AT ASSEMBLY.
- APPLY P/N 1-23419-5 LOCTITE(R) TO THREADS.
- WHEN CRIMPING TIN COATED 26 AWG WIRE, CRIMP HEIGHT TOLERANCE WILL BE STATED IN RELEVANT APPLICATION SPEC.

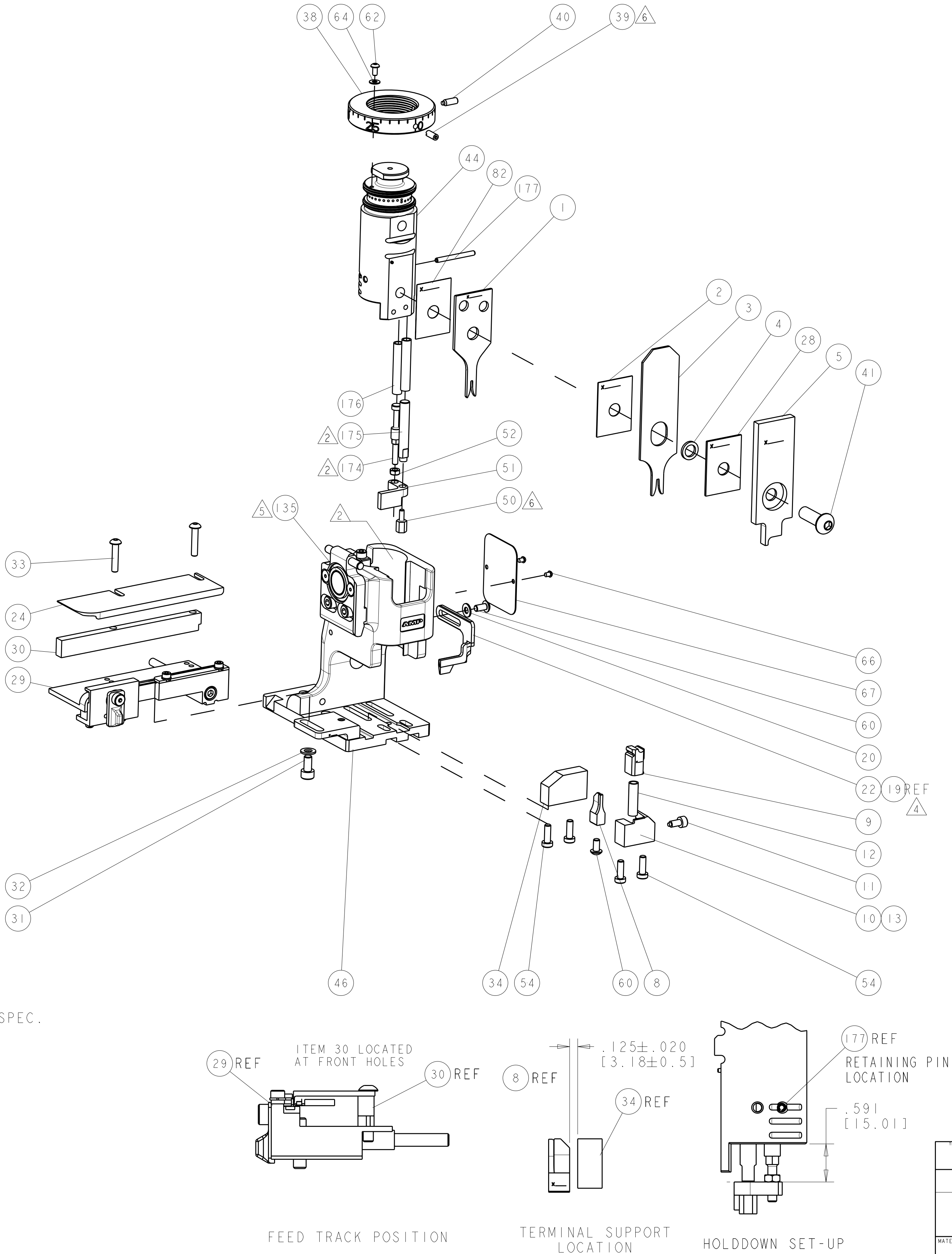

-	1	1	1	1	1-993111-6	PIN, SLOTTED SPRING 3.0 X 30.0	177
-	2	2	2	2	3-22280-7	SPRING, COMPRESSION	176
-	1	1	1	1	1752353-1	GUIDE PIN, HOLDDOWN	175
-	1	1	1	1	1901680-1	GUIDE PIN, HOLDDOWN	174
-	REF	REF	REF	REF	SEE TABLE	MEMORY CHIP, PROGRAMMED	135
-	1	1	1	1	455888-1	SPACER, CRIMPER	82
-	1	1	1	1	1633565-1	DOCUMENTATION PACKAGE	71
-	1	1	1	1	1901048-1	TAG, IDENTIFICATION	67
-	2	2	2	2	21017-1	SCREW, DRIVE	66
-	1	1	1	1	18028-1	WASHER, FLAT, REG M3	64
-	1	1	1	1	1655785-9	SCR, BTN SKT HD CAP (M3 X 6)	62
-	2	2	2	2	1655785-1	SCR, BTN SKT HD CAP (M4 X 8)	60
-	4	4	4	4	1655783-3	SCR, CAP, SOC HD, LOW HEAD, M4 X 12	54
-	1	1	1	1	1-18030-0	NUT, HEX, REG M3.5	52
-	1	1	1	1	1901681-1	HOLDDOWN, TERMINAL	51
-	1	1	1	1	1-1752354-4	STANDOFF, HOLD-DOWN	50
-	1	1	1	1	1752300-1	SF SYSTEM III APPLICATOR	46
-	1	1	1	1	1752308-1	RAM	44
-	1	1	1	1	2-1655785-3	SCR, BTN SKT HD CAP (M8 X 25)	41
-	1	1	1	1	993002-4	SCREW, SET, SFT TIP	40
-	1	1	1	1	1962043-1	PLUNGER, BALL, METRIC	39
-	1	1	1	1	1752309-1	RING, INSULATION CRIMP	38
-	1	1	1	1	1752356-1	SUPPORT, TERMINAL	34
-	2	2	2	2	3-1655785-3	SCR, BTN SKT HD CAP (M4 X 20)	33
-	1	1	1	1	18028-3	WASHER, FLAT, REG M5	32
-	1	1	1	1	5-1655316-3	SCR, SKT HD CAP, M5 X 10.0	31
-	1	1	1	1	1320908-4	SPACER, STRIP GUIDE	30
-	1	1	1	1	1901087-1	ASSEMBLY, STRIP GUIDE	29
-	1	1	1	1	1-455888-0	SPACER, CRIMPER	28
-	1	1	1	1	1320928-1	PLATE, STRIP GUIDE	24
-	1	1	1	1	1976045-1	STRIPPER	22
-	1	1	1	1	18028-2	WASHER, FLAT, REG M4	20
-	REF	REF	REF	REF	1752311-1	STRIPPER	19
-	1	-	1	-	1338684-1	SHEAR HOLDER, FRONT	13
-	1	1	1	1	3-22280-3	SPRING, COMPRESSION	12
-	1	1	1	1	356885-4	STOP, SHEAR	11
-	-	1	-	1	1320921-1	SHEAR HOLDER, FRONT, CUT	10
-	1	1	1	1	462006-1	FLOATING SHEAR, FRONT	9
-	1	2	1	1	1333225-9	ANVIL, COMBINATION	8
-	1	1	1	1	1-455889-4	DEPRESSOR, SHEAR	5
-	1	1	1	1	2-238011-5	BLOCK, CRIMPER SPACER	4
-	1	2	1	1	9-456134-4	CRIMPER, INSULATION F PREMIUM	3
-	1	1	1	1	455888-4	SPACER, CRIMPER	2
-	1	2	1	1	568176-6	CRIMPER, WIRE	1

TYPICAL DIMENSIONS: INCHES[mm]		TOLERANCES UNLESS OTHERWISE SPECIFIED:		DWN R. DOBSON 18MAR2008		CHK R. DOBSON 18MAR2008		APVD N. DEWING 18MAR2008		Tyco Electronics Harrisburg, PA 17105-3608	
9 PLC ±		10 PLC ±		11 PLC ±		12 PLC ±		13 PLC ±		NAME	
14 PLC ±		15 PLC ±		16 PLC ±		17 PLC ±		18 PLC ±		SIZE	
19 PLC ±		20 PLC ±		21 PLC ±		22 PLC ±		23 PLC ±		CAGE CODE	
24 PLC ±		25 PLC ±		26 PLC ±		27 PLC ±		28 PLC ±		DRAWING NO	
29 PLC ±		30 PLC ±		31 PLC ±		32 PLC ±		33 PLC ±		RESTRICTED TO	
34 PLC ±		35 PLC ±		36 PLC ±		37 PLC ±		38 PLC ±		A1 00779	
39 PLC ±		40 PLC ±		41 PLC ±		42 PLC ±		43 PLC ±		C=1911214	
44 PLC ±		45 PLC ±		46 PLC ±		47 PLC ±		48 PLC ±		SCALE	
49 PLC ±		50 PLC ±		51 PLC ±		52 PLC ±		53 PLC ±		3:5	
54 PLC ±		55 PLC ±		56 PLC ±		57 PLC ±		58 PLC ±		SHEET	
59 PLC ±		60 PLC ±		61 PLC ±		62 PLC ±		63 PLC ±		1	
64 PLC ±		65 PLC ±		66 PLC ±		67 PLC ±		68 PLC ±		OF	
69 PLC ±		70 PLC ±		71 PLC ±		72 PLC ±		73 PLC ±		REV	
74 PLC ±		75 PLC ±		76 PLC ±		77 PLC ±		78 PLC ±		A	

Mouser Electronics

Authorized Distributor

Click to View Pricing, Inventory, Delivery & Lifecycle Information:

[TE Connectivity:](#)

[1911214-6](#)