

A

B

C

D

A

B

C

D

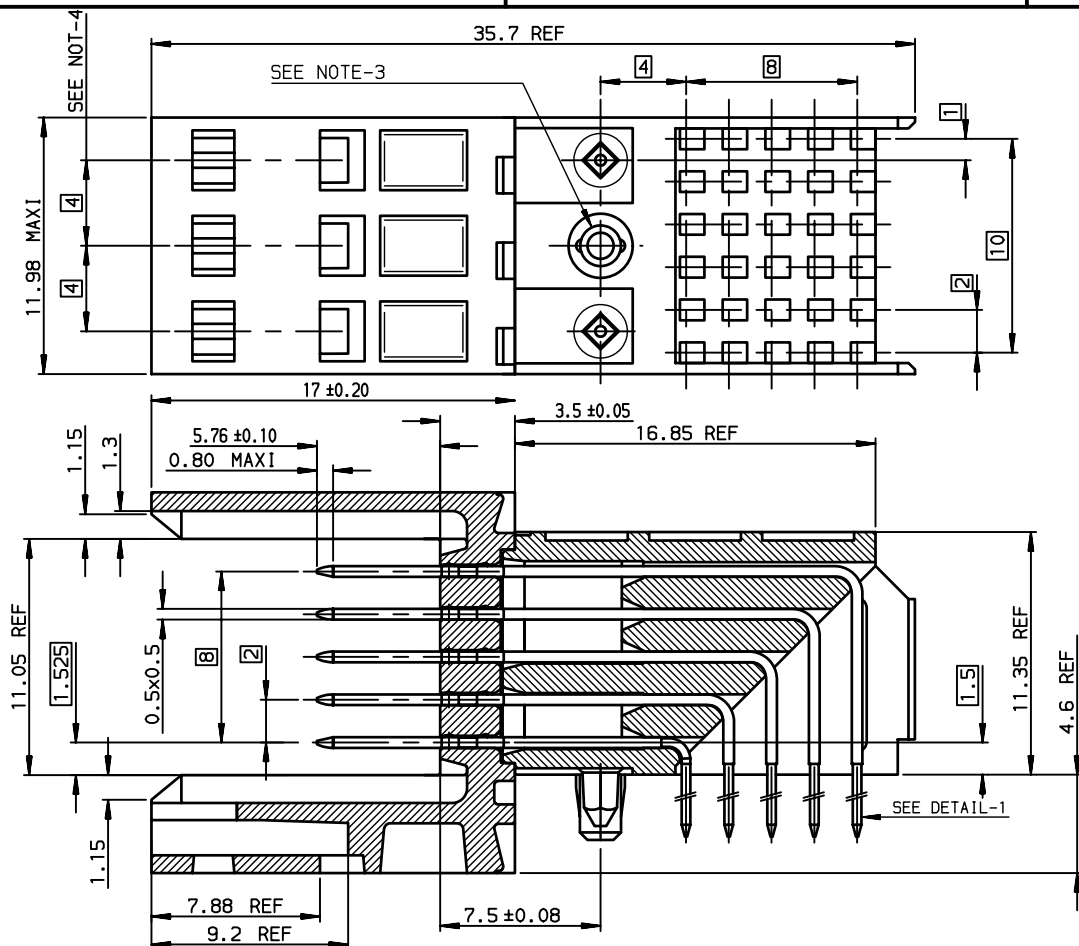

GENERAL CHARACTERISTICS AND ROHS INFORMATIONS:

SEE PRODUCT SPECIFICATION GS-12-446

- NOTE-2: DIMENSIONS ACCORDING TO IEC-48B-595NP DRAFT (FEBRUARY 97)
- NOTE-3: RETENTION DEVICES BEFORE SOLDERING BY FORCE FIT PEG.
- NOTE-4: 3 X CAVITY FOR PLASTIC LATCH
- NOTE-5: LATCH DIMENSIONS ACCORDING TO IEC-48B-595NP DRAFT
- NOTE-6: INFORMATIONS ON LATCH,SEE DRW C-8626-0314/0315/0316
- NOTE-7: IF SUFFIX "P" IS ADDED IN P/N PACKAGING IS IN TRAYS BUT CONNECTOR MARKING IS WITHOUT "P"
- EXAMPLE: HM1XXXXXXXXXH6P, MARKED HM1XXXXXXXXXH6

PART NUMBER

Part Number: HM1B51LAP000H6 (LF)

rev	ecn no	dr	date
D	-	CHA	1997/05/28
E	LS05-001	MLE	2005/03/15
F	LS06-0095	LGO	2006/07/10
G	LS07-0184	MLE	2007/07/24
H	LS08-0233	MLE	2008/12/18
-	-	-	-
-	-	-	-

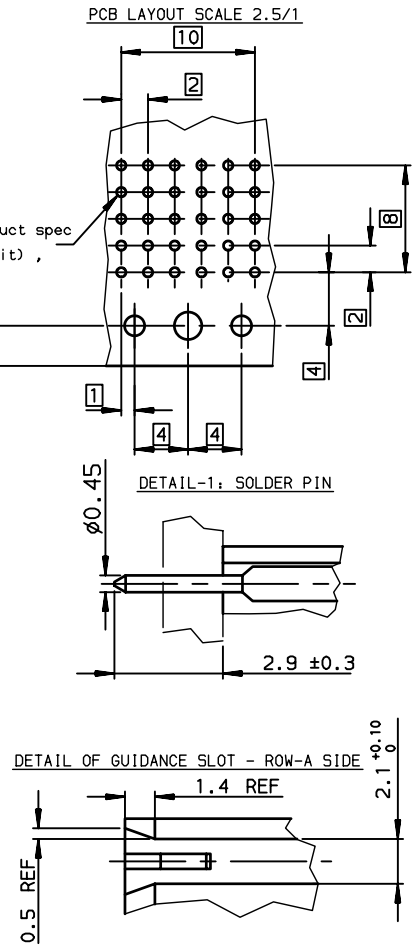
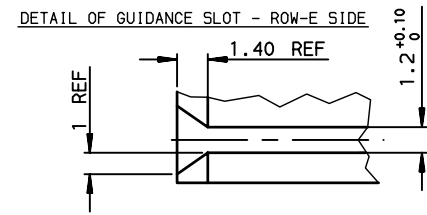
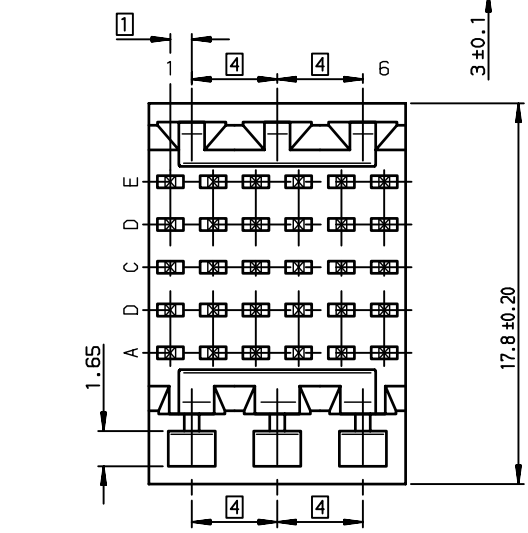
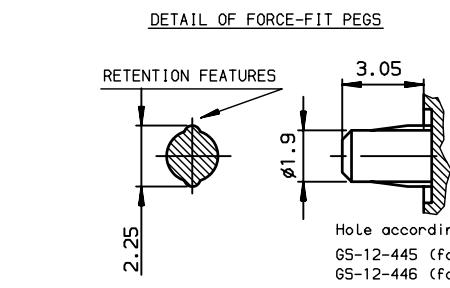

www.fciconnect.com			surface ISO 1302	tolerance std ISO 406 ISO 1101	projection mm	size A3		Scale 4
TOLERANCES UNLESS OTHERWISE SPECIFIED			ANGULAR	LINEAR	0.X ±0.1	ECN		LS08-0233
Dr CHAMPION 1996/10/07			0.XX ±0.1		Spec ref -			
Eng LENOIR 1996/10/07			0.XX ±0.1					
Chr LEGARE 1996/10/07			0.XX ±0.1					
Appr LEGARE 1996/10/07			Product family		METRAL			
FCI			HM1 MALE RA STB 30 WAY		C-8626-0312		Rev. H	
BOARD TO CABLE VERSION/UNSHIELDED			catalog no		CUSTOMER		sheet 1 of 1	

Mouser Electronics

Authorized Distributor

Click to View Pricing, Inventory, Delivery & Lifecycle Information:

FCI:

[HM1B51LAP000H6PLF](#)