

CM Series

Single Pole Power Rocker Switches

Features/Benefits

- Illuminated versions available
- Easy to install snap-in design
- Multiple actuator and termination styles to choose from

Typical Applications

- Computers and peripherals
- Power supplies
- Industrial equipment
- Small appliances
- RoHS compliant



Specifications

CONTACT RATING:

UL/CSA: 16 AMPS @ 125 VAC, 1/8 HP;
10 AMPS @ 250 VAC, 1/3 HP.

ELECTRICAL LIFE: 10,000 make and break cycles at full load.
INSULATION RESISTANCE: $10^8 \Omega$ min.

DIELECTRIC STRENGTH: 1,500 VRMS @ sea level.

OPERATING TEMPERATURE: -20°C to +80°C

Materials

HOUSING AND ACTUATOR: 6/6 nylon (UL94V-2), black, gloss or matte finish.

ILLUMINATED ACTUATOR: Polycarbonate, gloss or matte finish.

CENTER CONTACTS: Silver plated, copper alloy.

END CONTACTS: Silver plated.

ALL TERMINALS: Silver plated, copper alloy.

NOTE: Specifications and materials listed above are for switches with standard options. For information on specific and custom switches, consult Customer Service Center.

Build-A-Switch

To order, simply select desired option from each category and place in the appropriate box. Available options are shown and described on pages G-95 through G-97. For additional options not shown in catalog, consult Customer Service Center.

<div>Switch Function</div> <div>CM101 SPDT On-None-On</div> <div>CM102 SPST On-None-Off</div> <div>CM103 SPDT On-Off-On</div> <div>CM107 SPDT On-Off-Mom.</div> <div>CM12 * SPST On-None-Off</div>	<div>Actuator</div> <div>J1 Rocker</div> <div>J3 Illuminated rocker</div>	<div>Actuator Color</div> <div>2 Black</div> <div>1 White</div> <div>3 Red</div> <div>R Red, illuminated</div> <div>A Amber, illuminated</div> <div>G Green, illuminated</div>	<div>Mounting Style/Color</div> <div>S2 Snap-in, black</div> <div>S4 Snap-in, black</div> <div>S1 Snap-in, white</div> <div>S3 Snap-in, white</div>	<div>Termination</div> <div>05 .250" quick connect</div> <div>07 Solder lug</div>	<div>Actuator Marking</div> <div>(NONE) No marking</div> <div>D ON-OFF</div> <div>H "O I" - international ON-OFF</div> <div>P "O -" international ON-OFF</div>	<div>Contact Rating</div> <div>QA Silver</div>	<div>Lamp Rating</div> <div>(NONE) No lamp</div> <div>7 125 VAC neon</div> <div>8 250 VAC neon</div>
--	---	--	---	---	--	--	--

* CM12 - for switches with both marking and illumination

Rocker



G

C&K

Dimensions are shown: Inches (mm)
Specifications and dimensions subject to change

Technical drawing of a mechanical part with dimensions and tolerances:

- Top width: $.551$ ($14, 0$)
- Top width (inner): $.315$ ($8, 0$)
- Inner diameter: $.433$ ($11, 0$)
- Inner diameter (bottom): $.421$ ($10, 7$)
- Inner diameter (bottom): $.118$ DIA. ($3, 0$)
- Bottom width: $.250$ ($6, 35$)

G

CM Series Single Pole Power Rocker Switches

ACTUATOR COLOR

OPTION CODE	ACTUATOR COLOR
2	BLACK
1	WHITE
3	RED
R	RED, ILLUMINATED
A	AMBER, ILLUMINATED
G	GREEN, ILLUMINATED

MOUNTING STYLE/COLOR

S2 SNAP-IN, BLACK
S1 SNAP-IN, WHITE

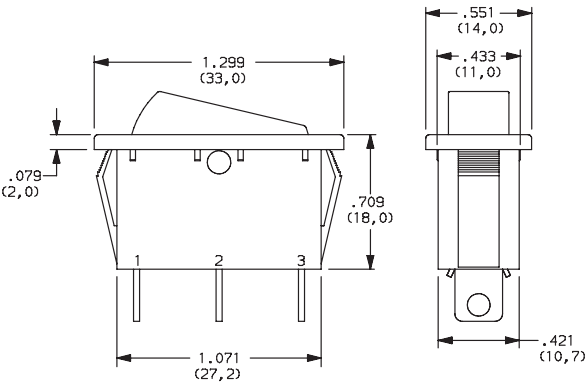

Shown in Pos. 1

S4 SNAP-IN, BLACK (SHORT FRAME)
S3 SNAP-IN, WHITE

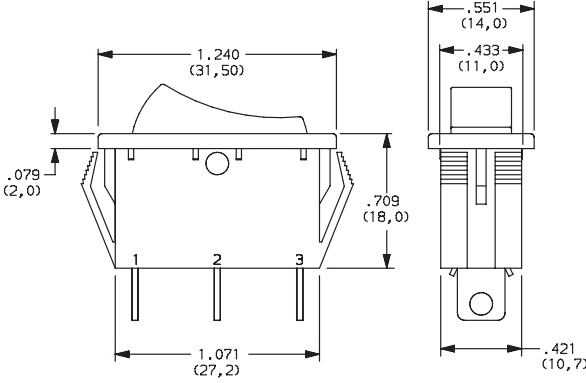

Shown in Pos. 1

PANEL MOUNTING

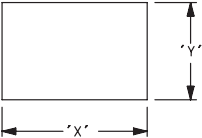

PANEL THICKNESS	"X"	"Y"
0.030-0.049 (0,75-1,25)	1.189-.004 (30,2-0,1)	0.441+.004 (11,2+0,1)
0.049-0.079 (1,25-2,0)	1.197-.004 (30,4-0,1)	0.441+.004 (11,2+0,1)
0.079-0.118 (2,0-3,0)	1.212-.004 (30,8-0,1)	0.441+.004 (11,2+0,1)

TERMINATION

05 .250 QUICK CONNECT

07 SOLDER LUG

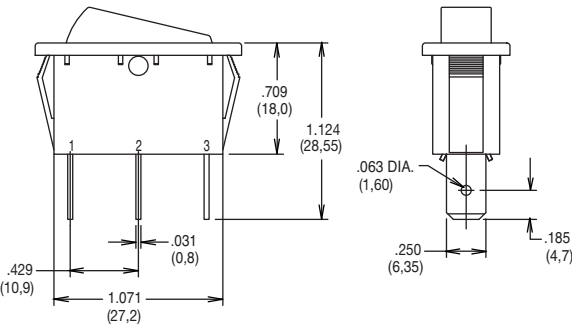

Shown in Pos. 1

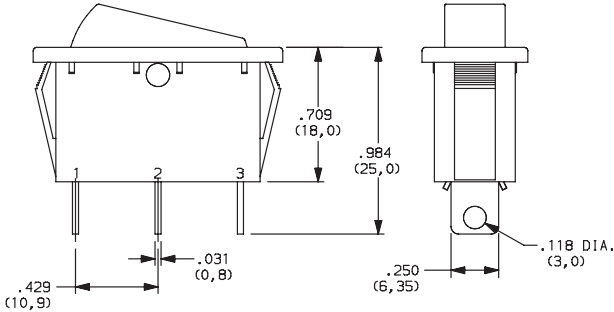

NOTE: Available with CM101 & CM102 switch functions only.

Rocker

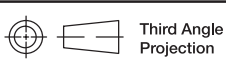

Dimensions are shown: Inches (mm)
Specifications and dimensions subject to change

CM Series Single Pole Power Rocker Switches

ACTUATOR MARKING

NONE NO MARKING



D ON-OFF



H 0 I

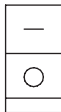

P 0 -

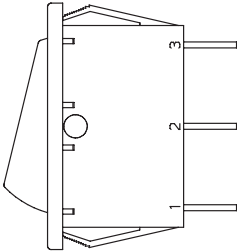

NOTE: Orientation of actuator marking and terminals.
Shown in Pos. 1

CONTACT MATERIAL

OPTION CODE	CONTACT AND TERMINAL MATERIAL	RATINGS	
		POWER	
QA	SILVER		16 AMPS @ 125 VAC; 1/8 HP 10 AMPS @ 250 VAC, 1/3 HP (UL/CSA).

* Note: See Technical Data section of this catalog for RoHS compliant and compatible definitions and specifications.

LAMP RATING

(NONE) NO LAMP

7 125 VAC 33kΩ NEON

8 250 VAC 150kΩ NEON

NOTE: Lamp rating for J3 & J8 actuator option.