

SLA3\_BUSS\_NAE\_GENRL\_REV\_A

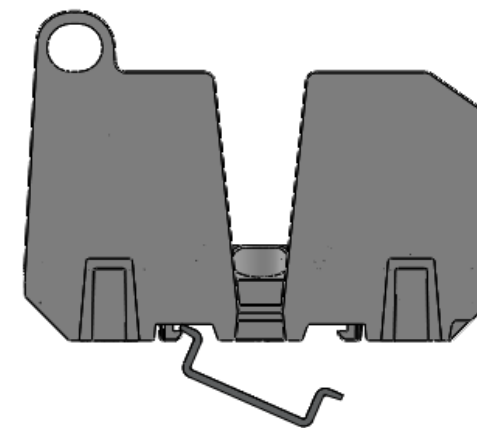

1. HOOK DIN RAIL SNAPS ON ONE SIDE OF THE DIN RAIL

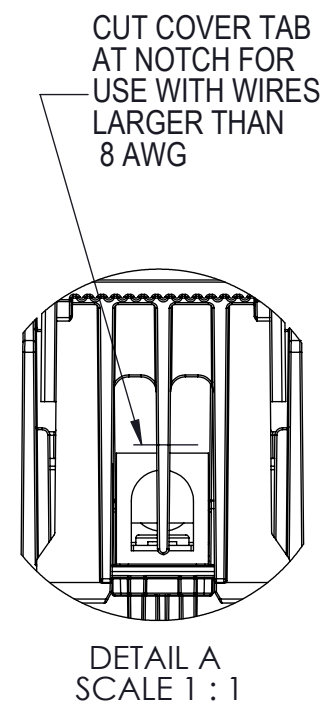
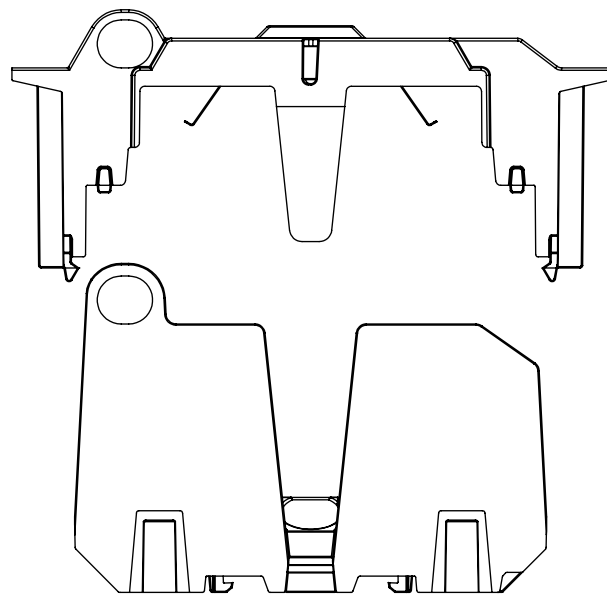
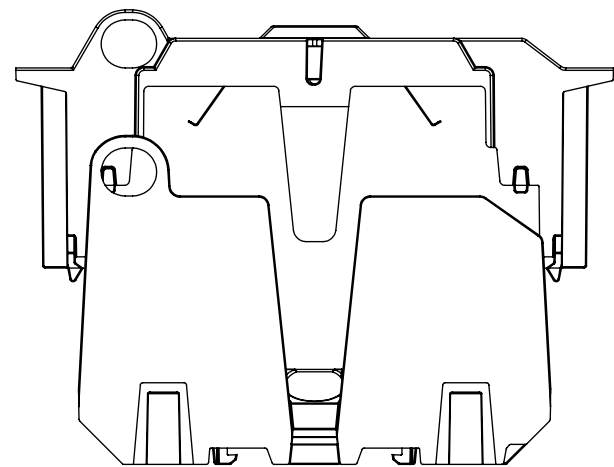
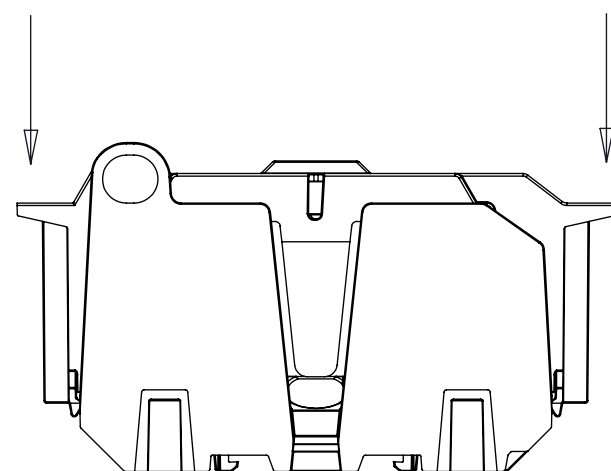

**CLOSING**  
PUSH STRAIGHT DOWN UNTIL SNAPS CLICK  
INTO PLACE

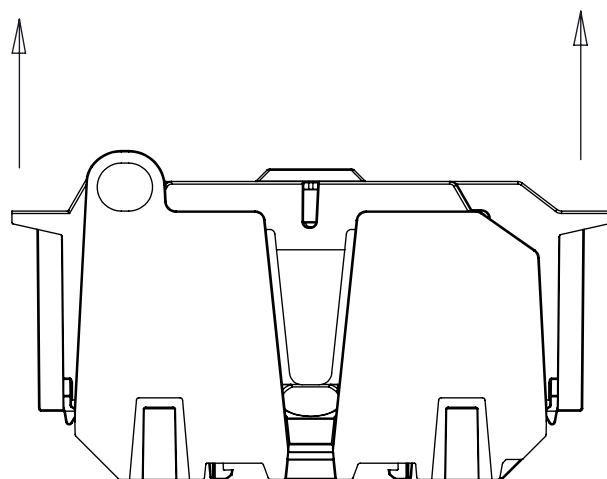

**OPENING**  
PULL STRAIGHT UP AT BOTH OUTSIDE  
HANDLES

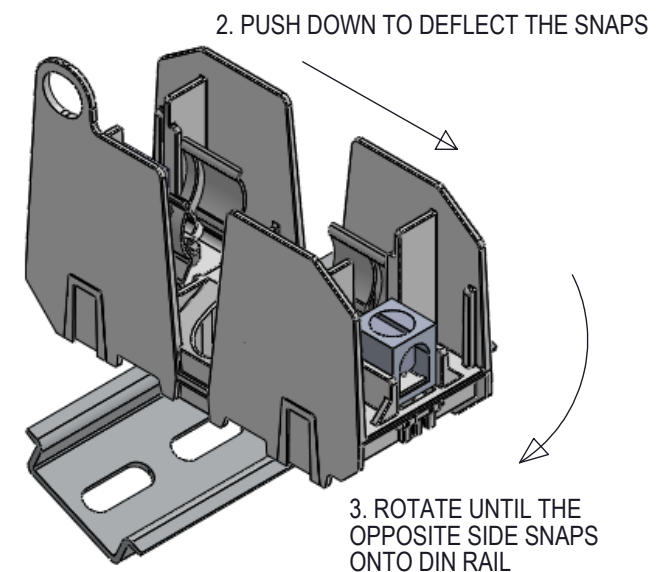
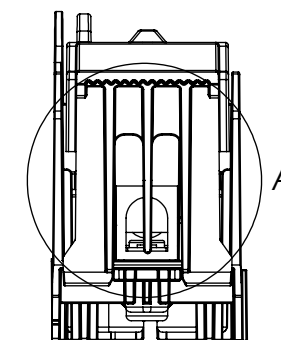

**INSTALLATION ON DIN RAIL**  
END STOPS MAY BE NECESSARY FOR SOME  
ASSEMBLY CONDITIONS - SEE NOTE 7

CUSTOMER PRINT

<b>Bussmann</b> by <b>E.T.N.</b>			
TITLE 700V / 100A 22X58 FUSE BLOCK			
SIZE <b>A3</b>	DWG NO. <b>JM70100-SERIES-CP</b>	REV <b>A</b>	
SCALE: 1:2	SHEET 2 OF 2		