

| DESCRIPTION | MATERIAL | FINISH |
|-------------|----------|--------|
| BODY        | BRASS    | NICKEL |
| PIN         | BeCu     | GOLD   |
| INSULATION  | PTFE     | N/A    |

| REVISIONS |   |           |      |
|-----------|---|-----------|------|
| REV       | DESCRIPTION   | DATE      | APPV |
| B         | ADDED NEW TITLE BLOCK; UPDATED DIMENSIONS AND FOOTPRINT | 5-MAR-12  | SAH  |
| C         | UPDATED MATERIALS                                       | 10-JUL-12 | SAH  |
| D         | ADDED DIMPLE TO PART                                    | 3-JUN-13  | SAH  |

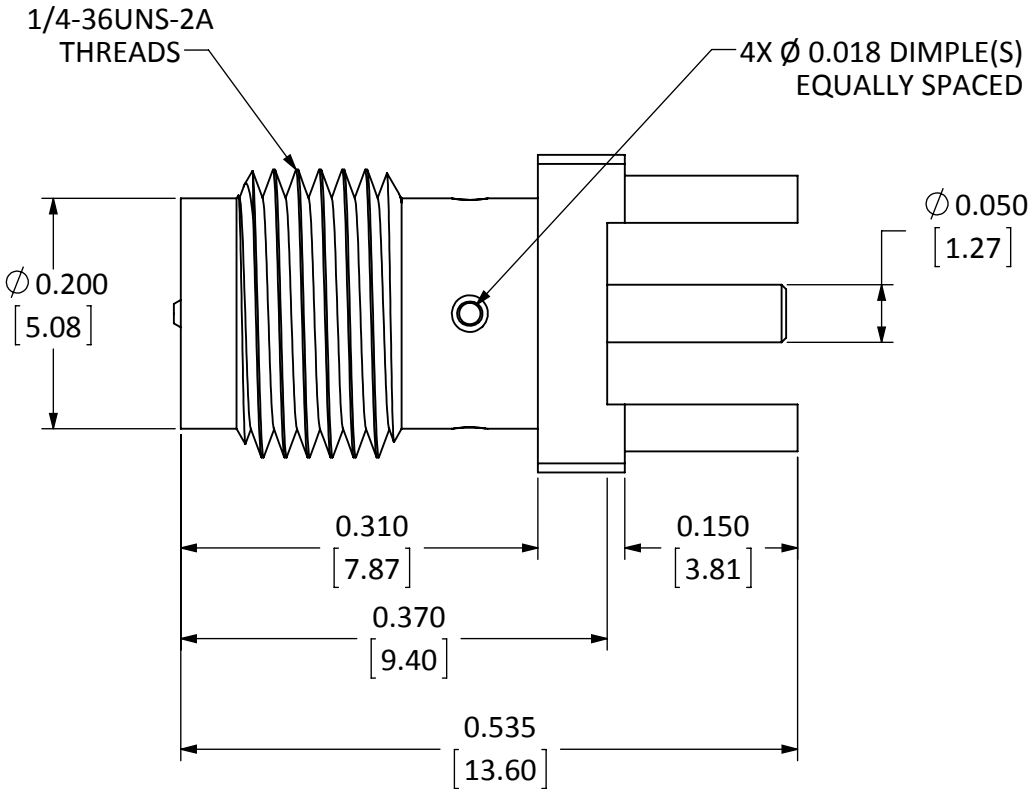

SIDE VIEW

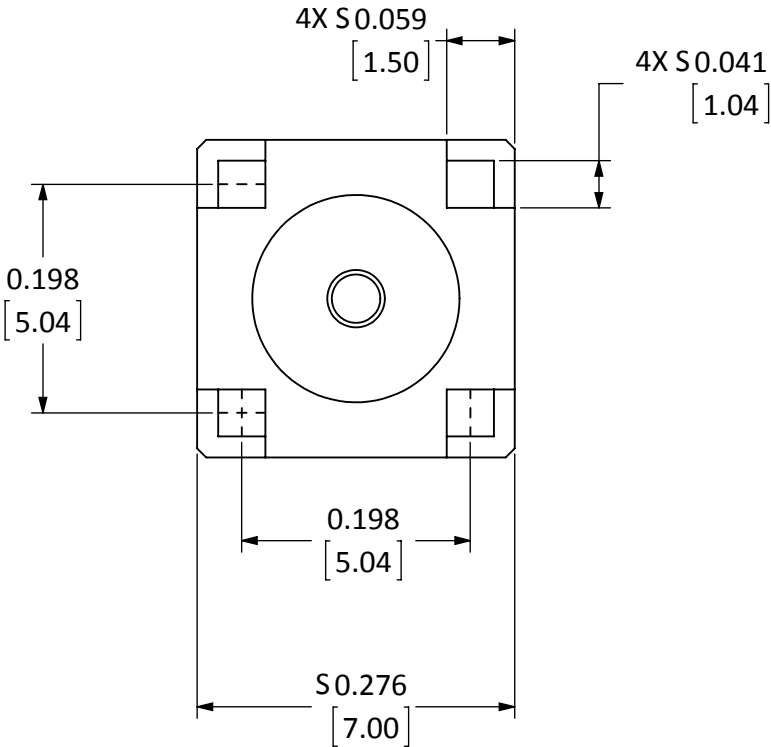

BOTTOM VIEW

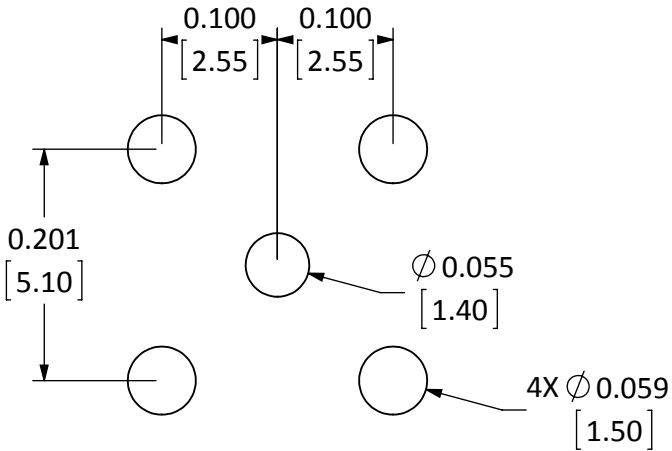

RECOMMENDED FOOTPRINT

- NOTES: (UNLESS OTHERWISE SPECIFIED)
1. ALL DIMENSIONS ARE IN INCHES [mm].
  2. DIMENSIONS APPLY AFTER FINISHING.
  3. MANUFACTURE TO BE COMPLIANT WITH EU RoHS DIRECTIVE.
  4. SAFETY BREAK ALL SHARP CORNERS AND EDGES .02 MAXIMUM.

|   |  |  |                              |  |                                  |
|---|--|--|------------------------------|--|----------------------------------|
| <b>WARNING:</b> THIS DRAWING CONTAINS PROPRIETARY INFORMATION THAT IS THE SOLE PROPERTY OF LINX TECHNOLOGIES, AND SHALL BE TREATED AS SUCH. NO DISCLOSURE OR REPRODUCTION OF THIS DOCUMENT IS PERMITTED, IN WHOLE OR IN PART, WITHOUT THE EXPRESS WRITTEN PERMISSION OF LINX TECHNOLOGIES OR ITS DESIGNATED AGENTS. |  |  |                              | <b>Linx</b> 159 ORT LANE<br>MERLIN, OR 97532 |                                  |
| MATERIAL:   |  | INTERPRET DIMENSIONS AND TOLERANCES PER ASME Y14.5.  | PROJECTION:                  | TITLE:<br><b>RP-SMA FEMALE<br/>PCB MOUNT</b> |                                  |
| FINISH:   |  | SURFACE FINISH: $\sqrt{32}$ ANGLES: $\pm 1^\circ$<br>TOLERANCES: .X $\pm .1$ .XX $\pm .01$ .XXX $\pm .005$ |                              | SIZE<br><b>B</b>                             | DWG. NO.<br><b>CONREV SMA001</b> |
|   |  | DRAWN: B.MURPHY<br>ENGR: S.HOGAN   | DT: 8-MAR-13<br>DT: 3-JUN-13 | REV<br><b>D</b>                              | SHEET 1 OF 1                     |

# Mouser Electronics

Authorized Distributor

Click to View Pricing, Inventory, Delivery & Lifecycle Information:

[Linx Technologies:](#)

[CONREV SMA001](#)