

RPCE-01-E-00.25-D-C5E

RPBE-01-01-E

RPBE, RPCE SERIES

IP68 SEALED ETHERNET SOCKET

Mates with:
RCE

SPECIFICATIONS

For complete specifications see www.samtec.com?RPBE

Insulator Material:

Black Liquid Crystal Polymer

Contact:

Phosphor Bronze

Operating Temp Range:

-40°C to +75°C

Seal:

Rubber

Screw:

Stainless Steel

Nut:

Stainless Steel

Sealing Washer:

Rubber

DUST CAPS

PORT	PART NO.	TYPE
-01	DCA-RPBE-01-01-P	Push-On/ No Latch
-01	DCA-RPBE-01-01-L	Latching
-02	DCA-RPBE-02-01-L	Latching

Note: Meets IP68 requirements for dust and waterproof sealing when mated or with dust cap.

RPBE

NO. OF
PORTSLEAD
STYLE

PLATING

-01, -02

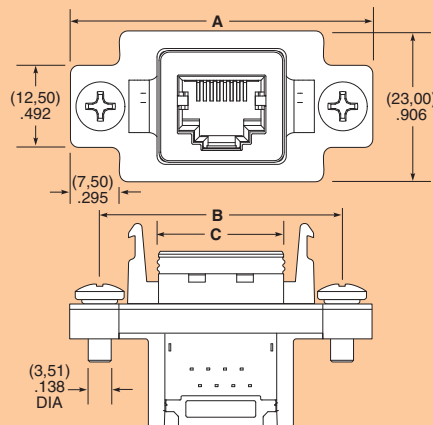
-01
= Right Angle-E
= 50µ" (1.27 µm) Gold on contact,
Flash Gold on tail

NO. OF PORTS	A	B	C
-01	(46,10) 1.815	(36,95) 1.455	(19,72) .776
-02	(67,10) 2.642	(57,95) 2.281	(40,72) 1.603

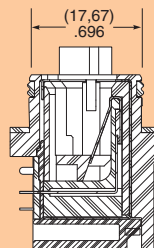

Some components
Removed for clarity

APPLICATION

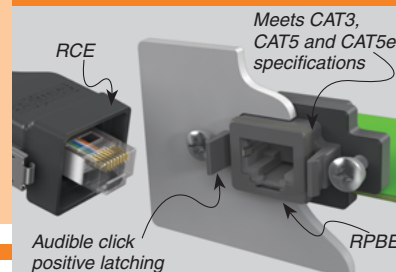

Mates with:
RCE

SPECIFICATIONS

For complete specifications see www.samtec.com?RPCE

Insulator Material:

Glass Filled Thermoplastic

Contact:

Phosphor Bronze

Shield:

Phosphor Bronze

Operating Temp Range:

-40°C to +75°C

Overmold:

Rite Flex 640F

Seal: Rubber

Screw: Stainless Steel

Nut: Stainless Steel

Sealing Washer: Rubber

Wire: 24 AWG

DUST CAPS

PORT	PART NO.	TYPE
-01	DCA-RPBE-01-01-P	Push-On/ No Latch
-01	DCA-RPBE-01-01-L	Latching
-02	DCA-RPBE-02-01-L	Latching

Note: Meets IP68 requirements for dust and waterproof sealing when mated or with dust cap.

RPCE

01

PLATING

WIRE
LENGTHEND
OPTION

C5E

-E

= 50µ" (1.27 µm) Gold on contact, Nickel on shell

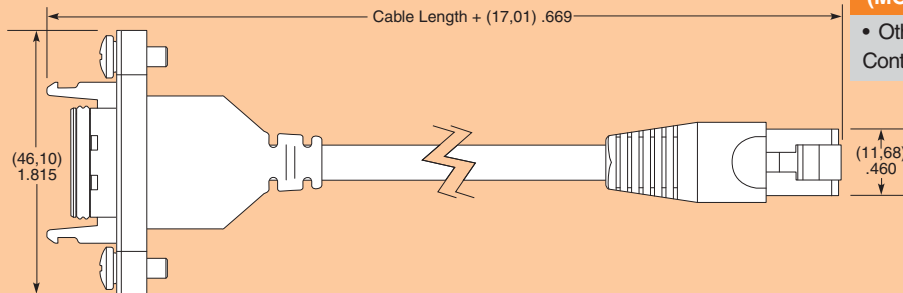
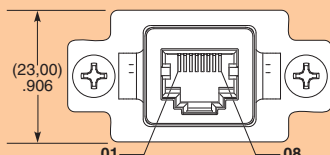
-00.25
= (0.25 m) 9.84"-00.50
= (0.50 m) 19.69"-D
= Double Ended-BC
= Blunt Cut

**ALSO
AVAILABLE
(MOQ Required)**

• Other wire lengths
Contact Samtec.

Due to technical progress, all designs, specifications and components are subject to change without notice.

WWW.SAMTEC.COM