

# DE SERIES PANEL MOUNT XLR CONNECTORS

NEW PRODUCT BULLETIN 603

## FEATURES & BENEFITS

- Same high quality connectors as our popular D Series XLR, except both male and female versions utilize the same size housing, simplifying installation and modification.
- Rugged metal construction.
- Available in nickel or black finish.
- Available with 3, 4, 5, 6 or 7 contacts, plated in silver or gold.
- Chassis ground terminal feature comes standard with all versions.
- RoHS Compliant.
- The perfect match for our QGPK Series of I/O panels and our WP Series of wall-plates. More info available on our website.



## APPLICATIONS

- Communications equipment
- Wall plates
- Custom I/O panels
- Pro audio equipment

# SWITCHCRAFT®

A H E I C O C O M P A N Y



5555 N Elston Ave | Chicago, IL 60630 | P: 773.792.2700 | F: 773.792.2129 | [www.switchcraft.com](http://www.switchcraft.com) | Made in USA.

# DE SERIES PANEL MOUNT XLR CONNECTORS

## NEW PRODUCT BULLETIN 603

### MALE DE SERIES CONNECTORS

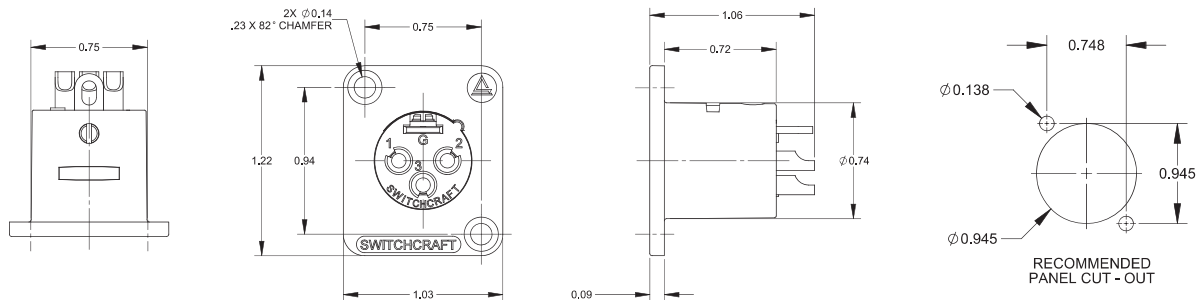

**DE** — **M** — — — — —  
NUMBER OF CONTACTS — — — — —  
3 - 3 CONTACTS  
4 - 4 CONTACTS  
5 - 5 CONTACTS  
6 - 6 CONTACTS  
7 - 7 CONTACTS  
MALE CONNECTOR — — — — —  
CONTACT PLATING  
BLANK - SILVER (STANDARD)  
AU - GOLD  
HOUSING FINISH  
BLANK - NICKEL  
B - BLACK  
BLANK - BULK PACKAGING  
PKG - INDIVIDUAL PACKAGE  
WITH SCREWS

INSERTS ARE GREEN FOR NICKEL HOUSING  
AND BLACK FOR BLACK HOUSING

#### NOTES:

1. MATERIALS:  
HOUSING - ZINC ALLOY, PLATED  
INSERT - THERMOPLASTIC, GREEN OR BLACK  
CONTACT PINS - COPPER ALLOY, PLATED  
SOLDER TERMINAL - COPPER ALLOY, TIN PLATED

2. THIS PART IS RoHS COMPLIANT.

### FEMALE DE SERIES CONNECTORS

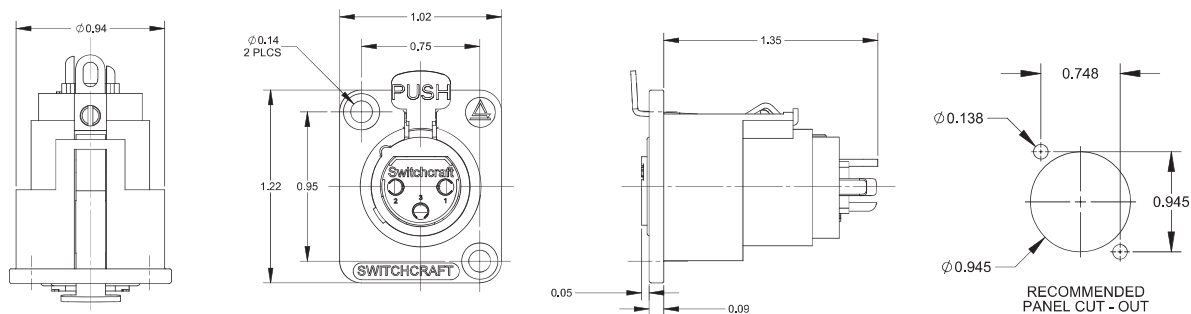

**DE** — **F** — — — — —  
NUMBER OF CONTACTS — — — — —  
3 - 3 CONTACTS  
4 - 4 CONTACTS  
5 - 5 CONTACTS  
6 - 6 CONTACTS  
7 - 7 CONTACTS  
FEMALE CONNECTOR — — — — —  
CONTACT PLATING  
BLANK - SILVER (STANDARD)  
AU - GOLD  
HOUSING FINISH  
BLANK - NICKEL  
B - BLACK  
BLANK - BULK PACKAGING  
PKG - INDIVIDUAL PACKAGE  
WITH SCREWS

INSERTS ARE GREEN FOR NICKEL HOUSING  
AND BLACK FOR BLACK HOUSING

#### NOTES:

1. MATERIALS:  
HOUSING - ZINC ALLOY, PLATED  
SHELL - STAINLESS STEEL  
SCREW - STAINLESS STEEL  
LATCH BUTTON - ZINC ALLOY, NICKEL PLATED  
INSERTS - THERMOPLASTIC, GREEN OR BLACK  
SOLDER TERMINAL - COPPER ALLOY, TIN PLATED  
LATCH SPRING - STAINLESS STEEL  
CONTACT SOCKETS - COPPER ALLOY, PLATED  
RELEASE LEVER - STEEL, PLATED

2. THIS PART IS RoHS COMPLIANT.

ALL DIMENSIONS ARE REFERENCE ONLY



Please visit [www.switchcraft.com](http://www.switchcraft.com) for the most up-to-date product specifications. Made in USA.

# Mouser Electronics

Authorized Distributor

Click to View Pricing, Inventory, Delivery & Lifecycle Information:

## Switchcraft:

[DE7M](#) [DE5FB](#) [DE3FB](#) [DE3MB](#) [DE4FBAU](#) [DE5F](#) [DE7MB](#) [DE6FB](#) [DE4MB](#) [DE6FBAU](#) [DE6MBAU](#) [DE7MBAU](#)  
[DE4F](#) [DE5MB](#) [DE3MBAU](#) [DE4FB](#) [DE4MBAU](#) [DE5MBAU](#) [DE7FBAU](#) [DE3MPKG](#) [DE3F](#) [DE5FBAU](#) [DE6MB](#) [DE4M](#)  
[DE7FB](#) [DE3FBAU](#) [DE3FPKG](#) [DE5M](#) [DE6F](#) [DE7F](#) [DE3M](#) [DE6M](#) [DE4FW](#) [DE4MW](#)